

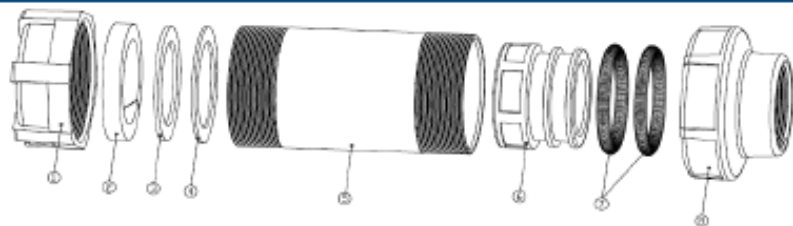

## TXJG Series Expansion Coupling for Rigid conduit and IMC Installation Instruction



### Parts:

1. Gland nut 2. Packing Ring 3. Metal Washer 4. Gasket 5. Body 6. Bushing  
7. Ground Springs 8. Reducer



EXPANSION JOINT CONDUIT FITTING  
SUITABLE FOR WET LOCATION

MAX EXPANSION 4"

CONDUIT SIZE 1-1/4"



CAUTION: DO NOT PAINT EXPANSION  
LENGTH OF CONDUIT ENTERING FITTING.

CAT. NO. TXJG44HDG



## Internal Ground

Bonding Jumper  
Not Required

1. Disassemble the product by unthreading the gland nut and sliding the reducer out of the body with a clockwise motion. You will get a assembly of gland nut with a piece of watertight packing ring, metal washer and gasket, a piece of bushing with 2 ground springs and a body with the reducer.



2. Slide the gland nut with packing ring, metal washer and gasket over the end of conduit. Thread the bushing with outer ground springs onto the conduit end and tighten until wrench-tight.



3. Fix the bushing and assemble the body with reducer by sliding it over the ground springs with a clockwise motion.



4. Move the end of conduit with bushing to the center of the TXJG body with clockwise motion. This will allow the conduit moving in either direction.
5. Thread fixed conduit into reducer and tighten until wrench-tight.
6. Thread gland nut with packing ring, gasket and metal washer onto the body and tighten securely to compress packing ring.

## Rigid Expansion Couplings

### Hot Dip Galvanized

#### Features

- c(UL)us listed wet locations-concrete tight
- Internal grounding design prevents a need for external bonding jumpers and cables
- Internal bonding springs and metallic bushings
- Helps prevent conduit from buckling and ensuing circuit failures
- Hot dip galvanized finish provides superior protection against severe environmental factors
- For use with Rigid UL 6 Conduit

#### Applications

- Allows up to 4" of linear movement caused by thermal expansion and contraction. (2" in either direction on center)
- Weatherproof design is suitable for use on outdoor structures prone to movement like bridges, railroads, and buildings
- Use to join two sections of conduit subjected to longitudinal movement

#### Standard Material

- Body: Steel
- Reducer: Malleable Iron
- Packing: PTFE composite
- Washer & Bushing: Malleable Iron
- Gasket: PTFE composite
- Grounding Spring: Beryllium Bronze-electrogalvanized

#### Standard Finish

- Hot dip galvanized



Conforms to finish thickness ASTM A338  
UL 3145  
NEMA FB1  
Wet location  
Federal Spec. WF-408E

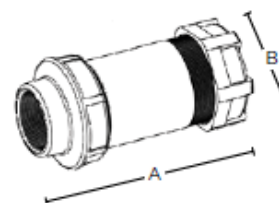

Catalog Number	UPC	Size	Ship Case	Weight/ Case	Inches	
					A	B
TXJG14HDG	17788	1/2"	1	3	6.86	1.81
TXJG24HDG	15050	3/4"	1	4	7.14	2.16
TXJG34HDG	15067	1"	1	5	7.66	2.66
TXJG44HDG	15074	1-1/4"	1	8	7.96	3.17
TXJG54HDG	15081	1-1/2"	1	13	8.31	3.7
TXJG64HDG	15098	2"	1	20	8.71	4.43
TXJG74HDG	15104	2-1/2"	1	27	9.93	4.93
TXJG84HDG	15111	3"	1	30	10.01	5.44
TXJG94HDG	15128	3-1/2"	1	48	10.44	6.7
TXJG104HDG	15135	4"	1	52	10.44	6.7

