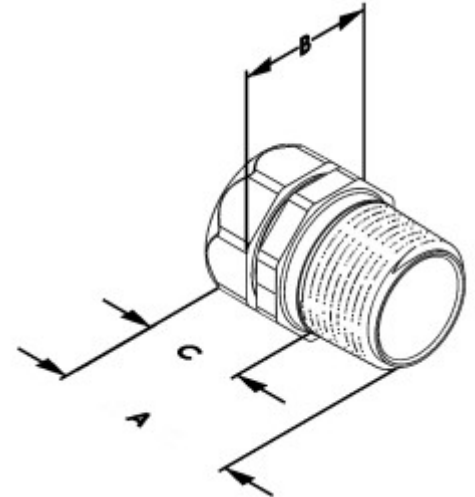

## Mighty-Seal® Raintight NPT 1/2" EMT to Threaded Entry Connector

Zinc Die Cast Connectors with NPT threads, used to secure EMT conduit to a threaded NPT hub. Provides a raintight /wet location seal when three

With Bridgeport's New RTNPT fittings, Contractors can correctly install a Listed connection in wet locations. An easy install that's meant to be used specifically Listed to be installed into threaded hubs, conduit bodies, and bosses. Done right, looks right and Inspector approved. That's how you know

[Download Photo](#)
[Download Drawing](#)

[Download Drawing](#)

### Product details

<b>Catalog Number:</b>	250-RTNPT
<b>UPC Number:</b>	78174797250
<b>Primary Materials:</b>	Zinc Die Cast
<b>Trade Size:</b>	1/2"
<b>Unit Quantity:</b>	25
<b>Standard Package Quantity:</b>	100

### Dimensions

<b>Trade Size:</b>	1/2"
<b>Dimensions A:</b>	1.700
<b>Dimensions B:</b>	1.000
<b>Dimensions C:</b>	1.075

### Certifications & Codes

**Federal Specification Number:** A-A-50553

**UNSPSC:** 39131707

**Nema Standard:** FB-1

**UL Standard:** Listed ETL Conforms to UL STD 514B Certified to CAN/CSA STD. C22.2 No. 18.3

**Patent Number:** US Patent 7,390,027