

CROUSE-HINDS
SERIES

Tray cable solutions

Cable glands for tray, non-armored and armored cable



EATON

Powering Business Worldwide

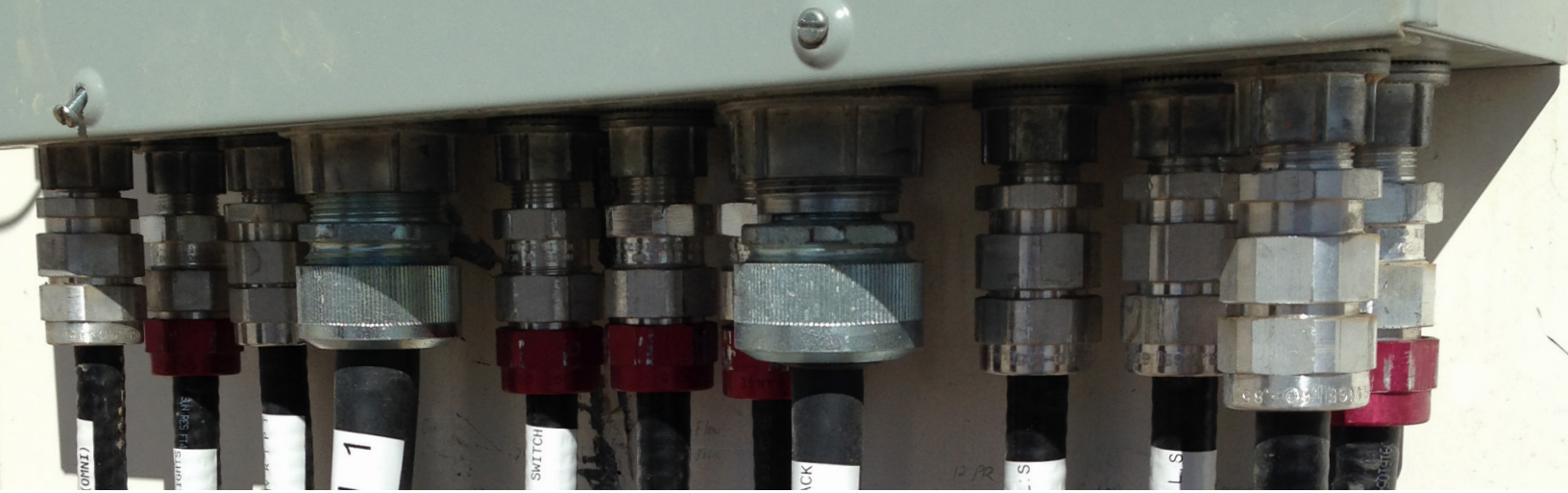

Fast & easy installation.

Gland solutions for tray cable

Eaton's Crouse-Hinds series cable glands are used in hazardous, industrial and commercial applications throughout the world, engineering safety and productivity in the most severe environmental conditions.

Our global offering provides a termination solution for virtually every cable type used in hazardous and industrial environments.

Designed for strict adherence to global specifications meeting North American and international codes and standards, including NEC, CEC, ATEX, IECEx and regional certifications.



CGB and CGE

CGB and CGE cord and cable connectors have been updated to accommodate termination of an even greater variety of cords and cables in dry and wet locations.

- Now certified for use with non-armored cords and cables, including tray cable types P, TC, TC-ER, TC-ER-HLA, ITC, ITC-ER, ITC-HL, PLTC and PLTC-ER cables
- Now UL Listed for use in wet locations
- Updated NEMA certifications - NEMA 4 in steel; NEMA 4X in aluminum
- Tested and listed with increased pull-out rating to 50 lbs. as required by UL for tray and TC-ER cables
- Rugged, durable construction protects cords and cables from damage, and compact design permits close grouping of several cords and/or cables
- Flexible offering available in both steel, iron and aluminum in $\frac{3}{8}$ " to 3" trade sizes in straight and 90° angles
- Wire mesh grips available for added strain relief



CGFP

CGFP cord and cable connectors have been updated to accommodate termination of an even greater variety of cords and cables in dry and wet locations.

- Now certified for use with non-armored cords and cables, including tray cable types P, TC, TC-ER, TC-ER-HLA, ITC, ITC-ER, ITC-HL, PLTC and PLTC-ER cables
- Tested and listed with increased pull-out rating to 50 lbs. as required by UL for tray and TC-ER cables
- Rugged, durable construction protects cords and cables from damage, and compact design permits close grouping of several cords and/or cables
- Flexible offering available in both steel and aluminum in 2" to 4" trade sizes in straight angles
- Wire mesh grips available for added strain relief



TMC3

TMC3 cable glands are ideal for terminating armored MC or TECK armored cable and non-armored tray cable in harsh, corrosive or heavy industrial areas and hazardous areas such as, drilling rigs, refineries, petrochemical, grain and mining applications.

- Now certified for use with non-armored cords and cables, including tray cable types MC, MC-HL, TECK, TC, TC-ER, TC-ER-HL, ITC, ITC-ER, ITC-HL, PLTC and PLTC-ER cables
- UL Listed for use in wet locations
- TMC3 cable glands form a mechanical watertight connection and may be installed in Class I, Division 2 locations, provided there are no arcing and sparking risks in accordance with NEC501.10B.



ADE-1F2 and ADE-1FC

ADE-1F2 and ADE-1FC cable glands are designed to provide a flameproof and weatherproof seal on the outer sheath of non-armored tray cable and marine shipboard or type P cable. ADE glands are available in a wide range of materials and sizes to suit any application. The ADE series is ideal for termination of cords and cables (including tray cables and TC-ER) with a wide range of global certifications and material options.

- The ADE-1F2 series is the ideal non-explosionproof gland for termination of cords and cables, tray cables (including TC-ER cable) when a wide range certifications, temperature range and material options are required.
- Designed for use in hazardous locations, the ADE-1FC series is the perfect barrier gland solution now certified Class I, Divisions 1 & 2, Groups A, B, C, and D for use with TC-ER-HL* cables, and carries a wide range of certifications, temperature ranges and material options.







Terminator II TMCX



Terminator™ II TMCX cable glands are truly universal hazardous location barrier cable glands designed for termination of armored, non-armored (including TC-ER-HL*) and TECK armored cables.

- Unique design features and broad range of sizes and materials, coupled with our fast-curing Chico® LiquidSeal compound and bulk packaging options, make the Terminator II TMCX the easiest, safest and most versatile cable termination solution available!

Ordinary location/heavy industrial use**

	Cable types	Form	Material options	Temperature rating	Standards	Hazardous rating	Sealing compound	Specifiable features
 CGB and CGE	<ul style="list-style-type: none"> • Non-armored • Tray 	<ul style="list-style-type: none"> • Straight • 90° 	<ul style="list-style-type: none"> • Steel • Aluminum 	-40°C to +100°C	• NEC		N/A	<ul style="list-style-type: none"> • Hex on body for easy wrenching • NEMA 4X (aluminum only)
 CGFP	<ul style="list-style-type: none"> • Non-armored • Tray 	<ul style="list-style-type: none"> • Straight 	<ul style="list-style-type: none"> • Steel • Feraloy iron alloy 	-25°C to +40°C	• NEC		N/A	<ul style="list-style-type: none"> • Hex on body for easy wrenching
 TMC3	<ul style="list-style-type: none"> • Armored • Non-armored • Tray 	<ul style="list-style-type: none"> • Straight 	<ul style="list-style-type: none"> • Nickel-plated brass • 316 stainless steel • Aluminum 	-60°C to +109°C	<ul style="list-style-type: none"> • NEC • IEC • ATEX 	<ul style="list-style-type: none"> • Suitable for use in Class I, Div. 2 hazardous locations when installed in accordance with NEC501.10(B)(4) 	N/A	<ul style="list-style-type: none"> • Hex on body for easy wrenching • 2-piece construction for faster installation
 ADE-1F2	<ul style="list-style-type: none"> • Non-armored • Tray • Marine shipboard • Type P 	<ul style="list-style-type: none"> • Straight 	<ul style="list-style-type: none"> • Nickel-plated brass • 316 stainless steel • Bronze • Aluminum 	-60°C to +140°C†	<ul style="list-style-type: none"> • NEC • IEC • ATEX 	<ul style="list-style-type: none"> • Class I, Zone 1 • Suitable for use in Class I, Div. 2 hazardous locations when installed in accordance with NEC501.10(B)(4) 	N/A	<ul style="list-style-type: none"> • Empty ingress seal, optional external clamping • NEMA 4X

Hazardous rated use

	Cable types	Form	Material options	Temperature rating	Standards	Hazardous rating	Sealing compound	Specifiable features
 ADE-1FC	<ul style="list-style-type: none"> • Non-armored • Tray • Marine shipboard • Type P 	<ul style="list-style-type: none"> • Straight 	<ul style="list-style-type: none"> • Nickel-plated brass • 316 stainless steel • Bronze • Aluminum 	-60°C to +80°C†	<ul style="list-style-type: none"> • NEC • IEC • ATEX 	<ul style="list-style-type: none"> • Class I, Division 1 • Class I, Zone 1 	TSC only	<ul style="list-style-type: none"> • Empty ingress seal, optional external clamping • NEMA 4X
 TMCX II	<ul style="list-style-type: none"> • Armored • Non-armored • Tray • TECK 	<ul style="list-style-type: none"> • Straight 	<ul style="list-style-type: none"> • Nickel-plated brass • 316 stainless steel • Aluminum 	-40°C to +60°C†	• NEC	<ul style="list-style-type: none"> • Class I, Division 1 	TSC or liquid (LSC)	<ul style="list-style-type: none"> • Integral union design with captive components • NEMA 4X/6P

*Type TC-ER-HL cable is rated for 600 V nominal. Overall cable diameters are 25 mm (1 inch) or less.

**Suitable for Class I, Division 2 hazardous locations when installed in accordance with NEC501.10(B)(4).

†Temperatures listed are operating temperatures. For additional certification information, consult factory.

CGB non-armored cable glands

Cable types:

Listed for use with:

- Flexible cords, including Type S, SO, STO, ST, SJ, SJT, SJTO and SVO
- Tray cable types P, TC, TC-ER, TC-ER-HLA, ITC, ITC-ER, ITC-HL, PLTC and PLTC-ER cables

Features:

- Rugged, durable construction protects cords and cables from damage and compact design permits close grouping of several cords and/or cables
- Flexible offering available in steel, iron and aluminum in 1/2" to 3" trade sizes
- Wire mesh grips available for added strain relief
- Available with NPT threads
- Standard silicone bushing weatherproof seal on outer sheath of cable

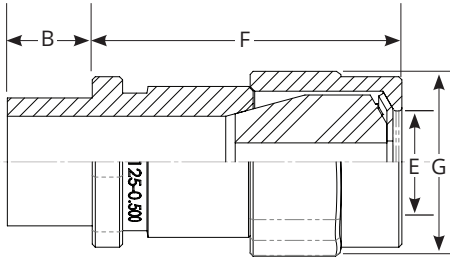

Certifications and compliances:

- cULus Listed – UL File No. E23223
- Suitable for use in Class I, Division 2 hazardous locations when installed in accordance with NEC501.10(B)(4)
- NEMA 3R (suitable for use in wet locations)
- NEMA 4 (1/2" to 3" steel only)
- NEMA 4X (1/2" to 1 1/2" aluminum only)

Standard materials and finishes:

- Bodies and gland nuts – steel with zinc electroplate and chromate finish coat
- Form E-F bodies and gland nuts – Feraloy® iron alloy with electrogalvanized and aluminum acrylic paint
- Available in all aluminum construction
- Bushing – standard silicone bushing included

Options:

Description

- Sealing gasket and locknut

Suffix

SG



Operating temperature:

- Tray cable/Type P: -40°C to +100°C
- Flexible cords: -40°C to +80°C



Ordering information:

NPT thread size	Form	Cat. #	Steel	Cat. # Aluminum	No. of bushings	Cable sealing range (E)		Dimensions		Optional				
						Min.	Max.	B	F	Across hex flats (G)	Across hex corners (G)	Cat. #	Wire mesh grip	
1/2"	-	CGB2-050-0		CGB2-050-0-SA	1	0.180	0.250	0.560	1.200	1.160	1.260			
1/2"	-	CGB2-050-1		CGB2-050-1-SA	1	0.250	0.375	0.560	1.200	1.160	1.260			
1/2"	-	CGB2-050-2		CGB2-050-2-SA	1	0.375	0.437	0.560	1.200	1.160	1.260			
3/4"	-	CGB2-075-0		CGB2-075-0-SA	1	0.180	0.250	0.570	1.200	1.160	1.260			
3/4"	-	CGB2-075-1		CGB2-075-1-SA	1	0.250	0.375	0.570	1.200	1.160	1.260			
3/4"	-	CGB2-075-2		CGB2-075-2-SA	1	0.375	0.500	0.570	1.200	1.160	1.260			
1/2"	-	CGB2-050-3		CGB2-050-3-SA	3	0.500	0.875	0.560	1.200	1.660	1.800			
3/4"	-	CGB2-075-3		CGB2-075-3-SA	3	0.500	0.875	0.570	1.200	1.660	1.800			
1"	-	CGB2-100-0		CGB2-100-0-SA	3	0.500	0.875	0.700	1.400	1.660	1.800			
1"	-	CGB2-100-1		CGB2-100-1-SA	3	0.875	1.375	0.700	1.480	2.340	2.520			
1 1/4"	-	CGB2-125-0		CGB2-125-0-SA	3	0.875	1.375	0.730	1.480	2.340	2.520			
1 1/4"	E	CGB4913		-	1	1.375	1.625	0.688	2.625	3.000*	-		RPE433-123	
1 1/4"	E	CGB4915		-	1	1.625	1.875	0.688	2.625	3.000*	-		17317N	
1 1/2"	D	CGB2-150-0		CGB2-150-0-SA	1	0.875	1.375	0.750	1.480	2.340	2.520			
1 1/2"	E	CGB5913		-	1	1.375	1.625	0.813	2.625	3.000*	-		RPE433-123	
1 1/2"	E	CGB5915		-	1	1.625	1.875	0.813	2.625	3.000*	-		17317N	
2"	E	CGB6913		CGB6913 SA	1	1.375	1.625	0.813	2.625	3.000*	-		RPE433-123	
2"	E	CGB6915		CGB6915 SA	1	1.625	1.875	0.813	2.625	3.000*	-		17317N	
2"	F	CGB6917		-	1	1.875	2.188	0.813	2.563	3.813*	-		17345N	
2"	F	CGB6920		-	1	2.188	2.500	0.813	2.563	3.813*	-		16772N	
2 1/2"	E	CGB7913		CGB7913 SA	1	1.375	1.625	1.000	2.625	3.125*	-		RPE433-123	
2 1/2"	E	CGB7915		CGB7915 SA	1	1.625	1.875	1.000	2.625	3.125*	-		17317N	
2 1/2"	F	CGB7917		CGB7917 SA	1	1.875	2.188	1.438	2.625	3.875*	-		17345N	
2 1/2"	F	CGB7920		-	1	2.188	2.500	1.438	2.625	3.875*	-		16772N	
3"	F	CGB8917**		CGB8917 SA	1	1.875	2.188	1.438	2.625	3.875*	-		17345N	
3"	F	CGB8920		CGB8920 SA	1	2.188	2.500	1.438	2.625	3.875*	-		16772N	

* Maximum operating temperature of bushing only; glands UL Listed to -25°C to +40°C.

** Not NEMA 4 or 4X rated.

CGE non-armored cable glands

Cable types:

Listed for use with:



- Flexible cords, including Type S, SO, STO, ST, SJ, SJT, SJTO and SVO
- Tray cable types P, TC, TC-ER, TC-ER-HL†, ITC, ITC-ER, ITC-HL, PLTC and PLTC-ER cables

Features:

- Rugged, durable construction protects cords and cables from damage and compact design permits close grouping of several cords and/or cables
- Wire mesh grips available for added strain relief
- Available with NPT threads
- Standard silicone bushing weatherproof seal on outer sheath of cable

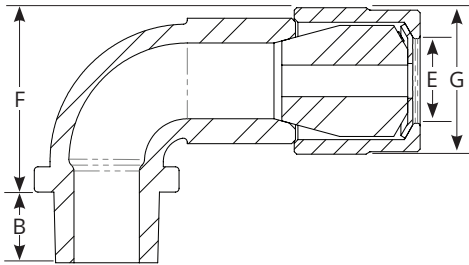

Certifications and compliances:

- cULus Listed – UL File No. E23223
- Suitable for use in wet locations
- NEMA 4

Standard materials:

- Body – Feraloy® iron alloy
- Gland nut – steel

Operating temperature:

- Tray cable/Type P: -40°C to +100°C
- Flexible cords: -40°C to +80°C

Options:

Description

- Sealing gasket and locknut

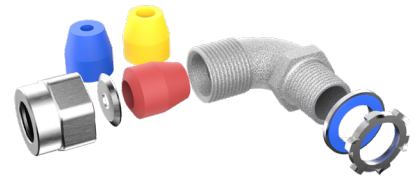

Suffix
SG

Ordering information:

NPT thread size	Cat. #	No. of bushings	Cable sealing range (E)		Dimensions		
			Min.	Max.	B	F	G
1/2"	CGE2-050-0	3	0.180	0.500	0.56	1.46	1.16
1/2"	CGE2-050-1	3	0.500	0.875	0.56	2.00	1.66
3/4"	CGE2-075-0	3	0.180	0.500	0.57	1.50	1.16
3/4"	CGE2-075-1	3	0.500	0.875	0.57	2.00	1.66
1"	CGE2-100-0	3	0.500	0.875	0.70	2.13	1.66
1"	CGE2-100-1	3	0.875	1.375	0.70	2.80	2.34

† Type TC-ER-HL cable is rated for 600V nominal. Overall cable diameters are 25mm (1") or less.

All dimensions in inches.

CGFP non-armored cable glands

Gland type:

- Non-armored

Cable type:

- Non-armored and tray cable

Features:

- Weatherproof seal on outer sheath of cable
- Available with NPT threads
- Refer to CGB2 for sizes less than 2" NPT

Certifications and compliances:

- Suitable for use in Class I, Division 2 hazardous locations when installed in accordance with NEC501.10(B)(2)

Standard materials:

- Form B-C bodies and gland nuts – turned steel
- Form D-G bodies and gland nuts – Feraloy® iron alloy

Operating temperature:

- Temperature rating: -25°C to +40°C

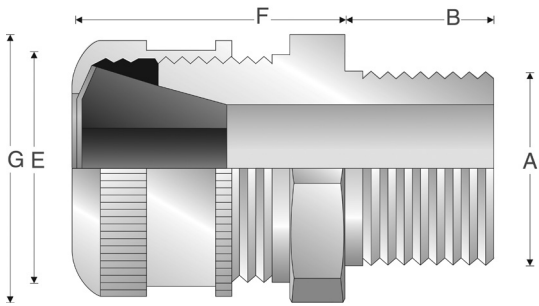

Ordering information:

Entry thread size (A)			Cable acceptance outer sheath				
NPT thread size	Cat. #	Form	NPT thread length (B)	Min.	Max.	Gland length less entry (F)	External diameter / hex (G)
2"	CGFP6913	E	1.000	1.375	1.625	3.250	3.250
2"	CGFP6915	E	1.000	1.625	1.875	3.250	3.250
2½"	CGFP7917	F	1.438	1.875	2.188	3.250	3.875
2½"	CGFP7920	F	1.438	2.188	2.500	3.250	3.875
3"	CGFP8917	F	1.500	1.875	2.188	3.250	3.875
3"	CGFP8920	F	1.500	2.188	2.500	3.250	3.875
3½"	CGFP923	G	1.563	2.500	3.000	4.250	5.500
3½"	CGFP927	G	1.563	3.000	3.500	4.250	5.500
4"	CGFP1023	G	1.625	2.500	3.000	4.250	5.500
4"	CGFP1027	G	1.625	3.000	3.500	4.250	5.500

All dimensions in inches.



TMC3 armored and non-armored cable glands

Cable types:

NEC certified for use with cable types:

- MC, MC-HL, TECK, TC, TC-ER, TC-ER-HL*, ITC, ITC-ER, ITC-HL, PLTC and PLTC-ER

CEC certified for use with cable types:

- TECK, ACIC, TC

Features:

- Multiple thread size options per sealing range eliminates need for adapters or reducers
- Full range of sizes from ½" to 2" NPT available
- Standard gasket and locknut ease installation and improve ingress protection (IP66 and NEMA 4X)
- Meets same bonding requirements as Myers hubs when installed in thin wall enclosures
- Extreme temperature range: -60°C to +109°C
- Corrosion-resistant material options: copper-free aluminum, nickel-plated brass or 316 stainless steel
- Cold Shrink™ kits available for extra protection in extreme environments (see Section 2G for more information)
- Eaton blue, anodized industrial grade nut (aluminum version only)
- Certification markings oriented for easy inspection when installed in the bottom of enclosures
- Dual certified for armored (MC/TECK) and non-armored (tray) cables
- Two-piece construction with locknut and gasket for faster installation
- Increased size of wrenching surfaces on body and nut
- The following part numbers are not listed for TC-ER-HL cables:
 - TMC3-100-2
 - TMC3-125-1
 - TMC3-150-2
 - TMC3-200-1

Certifications and compliances:



NEC/CEC:

- cULus to UL514B, UL2225, CSA C22.2 No. 18.3, CSA C22.2 No. 60079-0, -7, -31
- UL File No. E36379
- ATEX/IECEx to EN/IEC 60079-0, -7, -31
- ATEX File No. E483443
- NEMA 4X, IP66
- Listed for wet locations
- Listed for Class II, Division 1, Groups E, F, G and Class III
- Suitable for use in Class I, Division 2 locations, provided there are no arcing and sparking risks in accordance with NEC 501.10B

ATEX and IECEx and other global certifications:

- IECEx UL 19.0079X, DEMKO 19 ATEX 2260X, Ex eb IIC Ex tb IIIc



Standard materials:

- Body, gland nut and locknut – copper-free aluminum, nickel-plated brass or 316 stainless steel options
- Bushing and gasket – silicone
- Spring – copper alloy

Operating temperature:

- -60°C to +109°C

Patents:

- US20210226436A1 (Cable Gland Compression Limiter)
- US20210135436A1 (Cable Gland Bushing)
- US20210033136A1 (Hybrid Thread Geometry for Threaded Fitting)

*Type TC-ER-HL cable is rated for 600V nominal. Overall cable diameters are 25mm (1 inch) or less. The following part numbers are not listed for TC-ER-HL cables: **TMC3-100-2, TMC3-125-1, TMC3-150-2 and TMC3-200-1.**

Ordering information

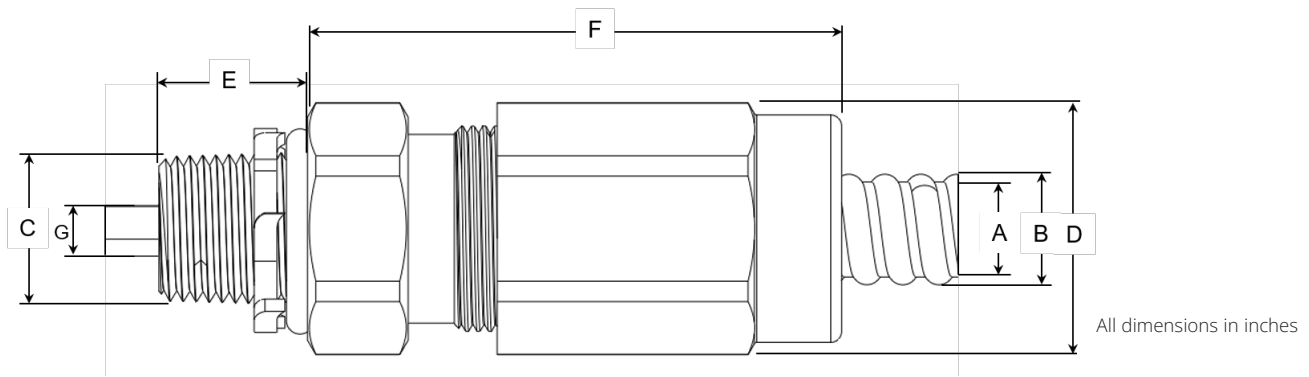

Entry thread NPT (C)	**Part #	Over conductors O.D max (G)*		Armored MC & MC-HL cables				Armored TECK90 cables				Un-armored TC & TC-ER-HL		Across corners (D)	Thread length (E)	Length (F)
		w/ armor stop	w/o armor stop	Armor O.D. (A)		Cable OD (B)		Armor O.D. (A)		Cable O.D. (B)*		Cable O.D. (B)*				
				Min.	Max.	Min.	Max.	Min.	Max.	Min.	Max.	Min.	Max.			
1/2"	TMC3-050-0	0.350	0.560	0.452	0.660	0.550	0.780	0.512	0.670	0.610	0.780	0.500	0.660	1.38	0.75	2.55
1/2"	TMC3-050-1	0.350	0.560	0.579	0.872	0.670	1.000	0.581	0.880	0.670	1.000	0.640	0.860	1.63	0.75	2.60
3/4"	TMC3-075-0	0.510	0.796	0.452	0.660	0.550	0.780	0.512	0.670	0.610	0.780	0.500	0.660	1.38	0.78	2.55
3/4"	TMC3-075-1	0.510	0.796	0.579	0.872	0.660	1.000	0.581	0.880	0.670	1.000	0.640	0.860	1.63	0.78	2.60
3/4"	TMC3-075-2	0.730	0.810	0.800	1.120	0.850	1.310	0.800	1.120	0.850	1.310	0.850	1.120	1.99	0.97	4.00
1"	TMC3-100-1	0.730	1.040	0.800	1.120	0.850	1.310	0.800	1.120	0.850	1.310	0.850	1.120	1.99	0.99	4.00
1"	TMC3-100-2	0.980	1.040	1.100	1.400	1.150	1.620	1.100	1.400	1.150	1.620	1.150	1.400	2.45	1.01	4.00
1-1/4"	TMC3-125-1	0.980	1.250	1.100	1.400	1.150	1.620	1.100	1.400	1.150	1.620	1.150	1.400	2.45	1.03	5.00
1-1/4"	TMC3-125-2	1.160	1.250	1.280	1.610	1.380	1.780	1.280	1.610	1.380	1.780	1.280	1.610	2.75	1.01	5.00
1-1/2"	TMC3-150-1	1.160	1.560	1.280	1.610	1.380	1.780	1.280	1.610	1.380	1.780	1.280	1.610	2.75	1.03	5.00
1-1/2"	TMC3-150-2	1.540	1.560	1.520	2.060	1.630	2.310	1.520	2.060	1.630	2.310	1.630	2.080	3.50	1.03	5.14
2"	TMC3-200-1	1.540	2.000	1.520	2.060	1.630	2.310	1.520	2.060	1.630	2.310	1.630	2.080	3.50	1.06	5.14

*When making your cable gland selection based on cable O.D., be sure to also observe the over conductors O.D. dimension and the armor O.D.

**Part numbers shown above are for aluminum, for stainless steel add "-SS" suffix, for nickel-plated brass add "-NP" suffix

ADE-1F2

ADE-1F2 cable glands are designed to provide a flameproof and weatherproof seal on the outer sheath of non-armored, tray, marine shipboard or type P cable. ADE glands are available in a wide range of corrosion resistant materials to suit any harsh, industrial applications.

Operating temperature:

- -60°C to +140°C

Materials:

- Nickel-plated brass for superior corrosion resistance
- 316 stainless steel, bronze and aluminum options available. It is recommended that a suitable lubricant be used on all threads of stainless steel and aluminum versions.

Ingress protection (IP):

- IP66 / IP68 according to the method of attachment and the condition of the equipment area. IP66 protection is achieved through thread to thread engagement. Additional protection up to IP68 can be achieved through the addition of sealing washer or thread sealant.
- NEMA 4X

Certifications and compliances:

ATEX certificate no: INERIS12ATEX0032X



- Zones 1 and 2, Groups IIA, IIB, IIC
- Zones 21 and 22, Groups IIIA, IIIB, IIIC
- Ⓢ II2GD / Ex db IIC / Ex eb IIC / Ex tb IIIC
- Ⓢ II3G Ex nRc IIC

IECEX certificate no: IECEX INE 12.0025X

- Zones 1 and 2, Groups IIA, IIB, IIC
- Zones 21 and 22, Groups IIIA, IIIB, IIC
- Ex db IIC / Ex eb IIC / Ex nRc IIC / Ex tb IIIC

UL certification

UL 3DJN E310130 Class I, Zone 1, AEx e II

- ADE sizes 3 to 8, ½" to 1¼" NPT or ISO 20 to 40 with TC-ER-HL non-armored cable up to 1" diameter



3DJN E310130 Class I, Zone 2, AEx e II, Ex e II

- ADE sizes 3 to 17, NPT ½" to 4" or ISO 20 to 110 with non-armored cable types ITC, MV, PLTC, TC-ER, TC-ER-HL, TC



3LRC E314047 Class I, Zone 2, AEx e II, Ex e II

- ADE sizes 3 to 17, NPT ½" to 4" or ISO 20 to 110 with non-armored marine cable
- Suitable for use in Class I, Div. 2 hazardous locations when installed in accordance with NEC501.10(B)(4)

Other certificates:

- CEPEL 05.0558X
- CCoE P360379-1
- KOSHA 2015.-BO-0249 to 0256
- NANIO TC-RU C-FR.Г05.B.00858
- NEPSI GY13.1082X
- SABS MS/15-0314

Shipping application:

- ABS 14-HS1274083-PDA
- BV 40910/A0 BV
- DNV TAE000010X
- Lloyds 11/00072
- DTS-01:1991 compliant



Cable types:

- Non-armored and tray cable – TC, TC-ER (HL)
- Marine shipboard cable; Type P cable



Provides 25% of cable clamping. As per IEC60079 § A.2.3.2 for group II or III cable glands, "Without a clamping device, additional clamping of the cable is needed to ensure that pulling and twisting is not transmitted to the terminations." We recommend using the certified ADE clamping module (see full-line catalog for details).

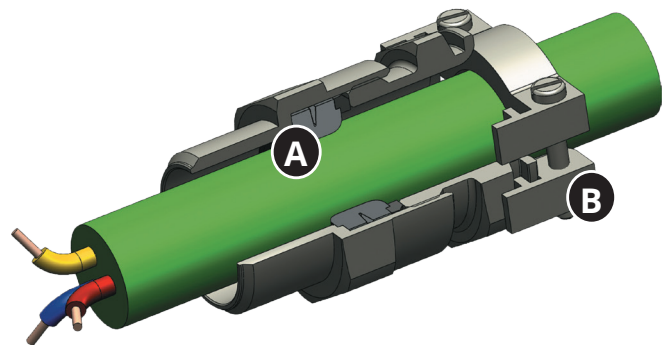

Design features:

- Ⓐ **Specifically formulated elastomer** – used on the outer sheath of the cable provides IP66 or IP68 moisture ingress protection
- Ⓑ **Optional external clamp** – provides additional external strain relief for rugged applications

Ordering information

Part number example ADE1N0752NPNK1

ADE-1F2 cable gland with 3/4" size hub, medium sealing range, nickel-plated brass, accessory kit #1

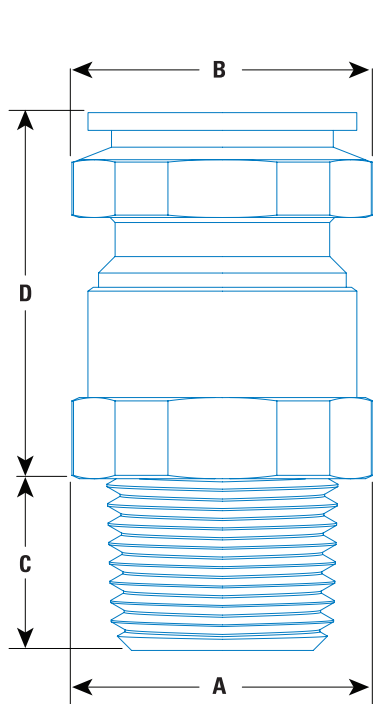

ADE1 N075

Hub size		Metric	
NPT	Hub	Metric	Hub
N025	1/4	M12	12
N038	3/8	M16	16
N050	1/2	M20	20
N075	3/4	M25	25
N100	1	M32	32
N125	1 1/4	M40	40
N150	1 1/2	M50	50
N200	2	M63	63
N250	2 1/2	M75	75
N300	3	M90	90
N350	3 1/2	M110	110
N400	4		

2 NPN K1

Sealing range		Accessory kits	
0	Extra small	BLANK	No kit
1	Small	K1	Locknut, green composite washer
2	Medium	K2	Locknut, green composite washer, earth tag, shroud
3	Large	K3	Locknut, green composite washer, earth tag, shroud, serrated washer

Material	
NPN	Nickel-plated brass
SSN	Stainless steel
BZN	Bronze
ALN	Aluminum

NPT hub sizes in inches Metric hub sizes in millimeters.

Cable sealing range

NPT thread size	NPT part number	Metric thread size	Metric part number	Size	Min. in. (mm)	Max. in. (mm)	NPT max.in. (mm)	A	B	NPT Threads (C)	Metric Threads (C)	D
1/4"	ADE1N0253NPN	M12	ADE1M123NPN	3	0.18 (4.5)	0.31 (8.0)		17	17	16.6	15.0	25.0
3/8"	ADE1N0382NPN	M16	ADE1M162NPN	2	0.18 (4.5)	0.33 (8.5)		17	17	16.6	15.0	25.0
3/8"	ADE1N0383NPN	M16	ADE1M163NPN	3	0.28 (7.0)	0.47 (12.0)		19	19	16.6	15.0	27.5
1/2"	ADE1N0500NPN	M20	ADE1M200NPN	0	0.11 (2.8)	0.22 (5.5)		15	15	22.2	15.0	24.0
1/2"	ADE1N0501NPN	M20	ADE1M201NPN	1	0.18 (4.5)	0.33 (8.5)		17	17	22.2	15.0	25.0
1/2"	ADE1N0502NPN	M20	ADE1M202NPN	2	0.28 (7.0)	0.47 (12.0)		19	19	22.2	15.0	27.5
1/2"	ADE1N0503NPN	M20	ADE1M203NPN	3	0.39 (10.0)	0.63 (16.0)	0.61 (15.5)	24	24	22.2	15.0	32.0
3/4"	ADE1N0751NPN	M25	ADE1M251NPN	1	0.28 (7.0)	0.47 (12.0)		19	19	22.2	15.0	27.5
3/4"	ADE1N0752NPN	M25	ADE1M252NPN	2	0.39 (10.0)	0.63 (16.0)		24	24	22.2	15.0	32.0
3/4"	ADE1N0753NPN	M25	ADE1M253NPN	3	0.53 (13.5)	0.81 (20.5)		30	30	22.2	15.0	36.5
1"	ADE1N1003NPN	M32	ADE1M323NPN	3	0.71 (18.0)	1.08 (27.5)	1.02 (26.0)	41	41	27.3	15.0	46.0
1 1/4"	ADE1N1252NPN	M40	ADE1M402NPN	2	0.71 (18.0)	1.08 (27.5)	1.02 (26.0)	48	48	28.0	15.0	50.0
1 1/4"	ADE1N1253NPN	M40	ADE1M403NPN	3	0.91 (23.0)	1.34 (34.0)		48	48	28.0	15.0	50.0
1 1/2"	ADE1N1501NPN	M50	ADE1M501NPN	1	1.14 (29.0)	1.61 (41.0)		55	55	28.5	16.0	52.0
2"	ADE1N2002NPN	M50	ADE1M502NPN	2	1.38 (35.0)	1.77 (45.0)	1.89 (48.0)	64	64	29.2	16.0	56.5
2"	ADE1N2003NPN	M63	ADE1M633NPN	3	1.65 (42.0)	2.2 (56.0)	2.09 (53.0)	72	72	29.2	17.0	60.0
2 1/2"	ADE1N2503NPN	M75	ADE1M753NPN	3	1.97 (50.0)	2.56 (65.0)	2.46 (62.5)	85	85	42.5	18.0	67.5
3"	ADE1N3002NPN	M90	ADE1M902NPN	2	2.28 (58.0)	2.91 (74.0)		95	95	44.0	22.0	69.0
3"	ADE1N3003NPN	M90	ADE1M903NPN	3	2.60 (66.0)	3.27 (83.0)	3.07 (78.0)	110	110	44.0	22.0	80.0
3 1/2"	ADE1N3502NPN	M110	ADE1M1102NPN	2	2.95 (75.0)	3.66 (93.0)	3.62 (92.0)	120	120	45.2	22.0	80.0
4"	ADE1N4003NPN	M110	ADE1M1103NPN	3	3.35 (85.0)	4.09 (104.0)		135	135	46.5	22.0	90.0

* Not UL certified

All dimensions in millimeters.
Above catalog numbers are for nickel-plated brass; refer to part number builder above for other options.

ADE-1FC

ADE-1FC cable glands are designed to provide a flameproof and weatherproof seal on the outer sheath of non-armored, tray marine shipboard or type P cable. ADE glands are available in a wide range of materials and sizes to suit any application.

Operating temperature:

- For all certificates (excluding UL E324850): -60°C to +80°C
- For UL certificate E324850: -20°C to +40°C

Materials:

- Nickel-plated brass for superior corrosion resistance
- 316 stainless steel, bronze and aluminum options available. It is recommended that a suitable lubricant is used on all threads of stainless steel and aluminum versions.

Ingress protection (IP):

- IP66 / IP68 according to the method of attachment and the condition of the equipment area
- NEMA 4X

Certifications and compliances:



ATEX certificate no: INERIS12ATEX0032X

- Zones 1 and 2, Groups IIA, IIB, IIC
- Zones 21 and 22, Groups IIIA, IIIB, IIIC
- Ex II2GD / Ex db IIC / Ex eb IIC / Ex tb IIIC
- Ex II3G Ex nRc IIC
- Ex IM2 / Ex db I / Ex eb I; for mining applications brass, stainless steel or bronze: ADE sizes 11 to 16; 2" to 4" NPT, ISO 63 to 110

IECEx certificate no: IECEx INE 12.0025X

- Zones 1 and 2, Groups IIA, IIB, IIC
- Zones 21 and 22, Groups IIIA, IIIB, IIC
- Ex db IIC / Ex eb IIC / Ex nRc IIC / Ex tb IIIC
- Ex db I / Ex eb I; for mining applications brass, stainless steel or bronze ADE sizes 11 to 16; 2" to 4" NPT, ISO 63 to 110

UL certification



3DJN E310130 Class I, Zone 2, AEx de II, Ex de II

- ADE sizes 4 to 16, NPT 1/2" to 4" or ISO 20 to 110 with non-armored cable types ITC, MV, PLTC, TC-ER, TC-ER-HL, TC and with TSC epoxy sealing compound



3DJN E310130 Class I, Division 1, Groups A, B, C, and D

- ADE sizes 4 to 9, NPT 1/2" to 1 1/4" or ISO 20 to 40 with non-armored cable type TC-ER-HL and TSC epoxy sealing compound
- ADE sizes 4 to 16, NPT 1/2" to 4" or ISO 20 to 110 with non-armored cable type ITC-HL and with TSC epoxy sealing compound



3DJN E310130 Class I, Division 2, Groups A, B, C, and D

- ADE sizes 4 to 16, NPT 1/2" to 4" or ISO 20 to 110 with non-armored cable types PLTC, PLTC-ER, ITC, ITC-ER, ITC-HL, TC, TC-ER, TC-ER-HL, MV and with TSC epoxy sealing compound



4EC5 E324850 Class I, Division 2, Groups A, B, C, and D

- ADE sizes 4 to 16, NPT 1/2" to 4" or ISO 20 to 110 with non-armored marine cable and with TSC epoxy sealing compound



Cable types:

- Non-armored and tray cable – TC, TC-ER (HL)
- Marine shipboard cable; Type P cable

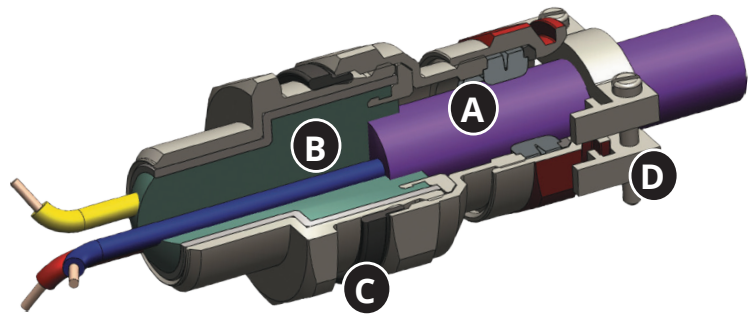

Design features:

- (A) **Specifically formulated elastomer gasket** – seals the outer sheath of the cable providing IP66 or IP68 moisture ingress protection
- (B) **Barrier compound chamber** – seals conductors for explosionproof applications.
- (C) **Deluge seal** – additional protection against moisture ingress
- (D) **Optional external clamp** – provides additional external strain relief for rugged applications

Other certificates:

- CEPEL 05.0558X
- CCoE P360379-1
- KOSHA 2015.-BO-0479 to 0482
- NANIO TC-RU C-FR.ГБ05.B.00858
- NEPSI GYJ13.1082X
- SABS MS/15-0314X

Shipping application:

- ABS 14-HS1274083-PDA
- BV 40910/A0 BV
- DNV TAE000010X
- Lloyds 11/00072
- DTS-01:1991 compliant

Ordering information

Part number example

ADE1CM253NPSCNK1

ADE-1FC cable gland, 25mm hub size, large size sealing range, nickel-plated brass, solid sealing compound, accessory kit #1

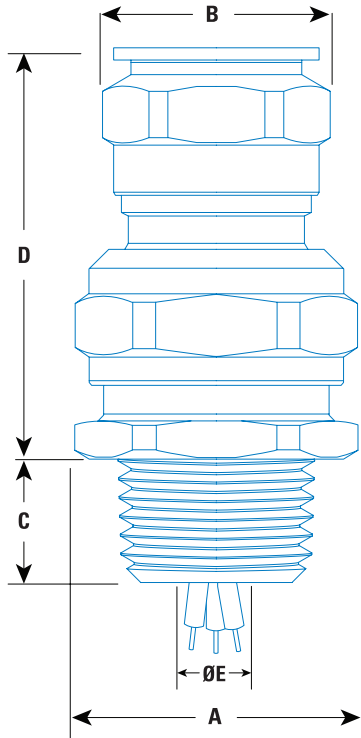

ADE1C

M25

3

NP

SCN

K1

Hub Size

NPT	Hub
N038	3/8
N050	1/2
N075	3/4
N100	1
N125	1 1/4
N150	1 1/2
N200	2
N250	2 1/2
N300	3
N350	3 1/2
N400	4

NPT hub sizes in inches

Metric	Hub
M16	16
M20	20
M25	25
M32	32
M40	40
M50	50
M63	63
M75	75
M90	90
M110	110

Metric hub sizes in millimeters.

Sealing range

0	Extra small
1	Small
2	Medium
3	Large

Material

NP	Nickel-plated brass
SS	Stainless steel

Sealing compound

SCN	Solid compound
-----	----------------

Accessory kits

BLANK	No kit
K1	Lock nut, green composite washer
K2	Lock nut, green composite washer, earth tag, shroud
K3	Lock nut, green composite washer, earth tag, shroud, serrated washer

Cable sealing range

NPT thread size	NPT part number	Metric thread size	Metric part number	Size	Min. in. (mm)	Max. in. (mm)	A	B	NPT Threads (C)	Metric Threads (C)	D	E	Max. # of cores
3/8"	ADE1CN0383NPSCN	M16	ADE1CM163NPSCN	3	0.16 (4.0)	0.33 (8.5)	19.0	15.0	16.6	15.0	36.0	6.5	6
1/2"	ADE1CN0501NPSCN	M20	ADE1CM201NPSCN	1	0.16 (4.0)	0.33 (8.5)	24.0	15.0	22.2	15.0	36.0	6.5	6
1/2"	ADE1CN0502NPSCN	M20	ADE1CM202NPSCN	2	0.24 (6.0)	0.47 (12.0)	24.0	19.0	22.2	15.0	42.0	9.5	6
1/2"	ADE1CN0503NPSCN	M20	ADE1CM203NPSCN	3	0.33 (8.5)	0.63 (16.0)	30.0	24.0	22.2	15.0	48.0	12.0	10
3/4"	ADE1CN0752NPSCN	M25	ADE1CM252NPSCN	2	0.33 (8.5)	0.63 (16.0)	30.0	24.0	22.5	15.0	48.0	12.0	10
3/4"	ADE1CN0753NPSCN	M25	ADE1CM253NPSCN	3	0.47 (12.0)	0.83 (21.0)	41.0	30.0	22.5	15.0	58.0	17.0	21
1"	ADE1CN1002NPSCN	M32	ADE1CM322NPSCN	2	0.47 (12.0)	0.83 (21.0)	41.0	30.0	27.3	15.0	58.0	17.0	21
1"	ADE1CN1003NPSCN	M32	ADE1CM323NPSCN	3	0.63 (16.0)	1.08 (27.5)	48.0	41.0	27.3	15.0	70.0	23.0	42
1 1/4"	ADE1CN1252NPSCN	M40	ADE1CM402NPSCN	2	0.63 (16.0)	1.08 (27.5)	48.0	41.0	28.0	15.0	70.0	23.0	42
1 1/4"	ADE1CN1253NPSCN	M40	ADE1CM403NPSCN	3	0.83 (21.0)	1.34 (34.0)	55.0	48.0	28.0	15.0	79.0	29.0	60
1 1/2"	ADE1CN1502NPSCN	M50	ADE1CM502NPSCN	2	0.83 (21.0)	1.34 (34.0)	55.0	48.0	28.5	16.0	79.0	29.0	60
2"	ADE1CN2001NPSCN	M50	ADE1CM501NPSCN	1	1.06 (27.0)	1.61 (41.0)	64.0	55.0	29.2	16.0	88.0	36.5	80
2"	ADE1CN2002NPSCN	M63	ADE1CM632NPSCN	2	1.3 (33.0)	1.89 (48.0)	72.0	64.0	29.2	17.0	98.0	43.0	100
2"	ADE1CN2003NPSCN	M63	ADE1CM633NPSCN	3	1.57 (40.0)	2.20 (56.0)	85.0	72.0	29.2	17.0	103.0	50.0	100
2 1/2"	ADE1CN2502NPSCN	-	-	2	1.57 (40.0)	2.20 (56.0)	85.0	72.0	42.5	-	103.0	50.0	100
2 1/2"	ADE1CN2503NPSCN	M75	ADE1CM753NPSCN	3	1.81 (46.0)	2.56 (65.0)	95.0	85.0	42.5	18.0	111.0	59.0	120
3"	ADE1CN3001NPSCN	-	-	1	1.81 (46.0)	2.56 (65.0)	95.0	85.0	44.0	-	111.0	59.0	120
3"	ADE1CN3002NPSCN	M90	ADE1CM902NPSCN	2	2.13 (54.0)	2.91 (74.0)	110.0	95.0	44.0	22.0	120.0	66.0	140
3 1/2"	ADE1CN3502NPSCN	-	-	2	2.13 (54.0)	2.91 (74.0)	110.0	95.0	45.2	-	120.0	66.0	140
3"	ADE1CN3003NPSCN	M90	ADE1CM903NPSCN	3	2.48 (63.0)	3.27 (83.0)	120.0	110.0	44.0	22.0	125.0	75.0	140
3 1/2"	ADE1CN3503NPSCN	-	-	3	2.48 (63.0)	3.27 (83.0)	120.0	110.0	45.2	-	125.0	75.0	140
4"	ADE1CN4003NPSCN	M110	ADE1CM1103NPSCN	3	2.83 (72.0)	3.66 (93.0)	135.0	120.0	46.5	22.0	128.0	85.0	200

* Not UL certified

All dimensions in millimeters.

Above catalog numbers are for nickel-plated brass; refer to part number builder above for other options.

Terminator II TMCX

The Terminator II TMCX cable gland is used to terminate armored barrier, non-armored barrier and TECK armored cable in hazardous locations. Its unique design features, coupled with our new fast curing Chico LiquidSeal compound, make the Terminator II TMCX the easiest and safest solution available.

Features and benefits:

- Designed to minimize the opportunity for incorrect assembly
- Simple selection process and field preparation aids to ensure the right gland is selected every time
- Full coverage of all popular cables and hub sizes, ensuring a perfect seal in all instances
- Use of nickel-plated brass and stainless steel to increase corrosion resistance and maintain integrity in the harshest environments
- Chico LiquidSeal, an innovative liquid compound with fast gel and cure times, reduces waiting times
- Complete with integral dam to facilitate liquid pour
- Integral union design reduces the number of times the gland has to be assembled and disassembled during installation
- Mating components have generous lead-ins to ensure that assembly is as trouble-free as possible, even with the heaviest cables
- Use of neoprene seal allows use in temperatures from -40°C to +60°C; for specific temperature information, please contact your local sales representative
- Metric size threads allow interfacing to European machinery

Cable types:

- Metal-clad and TECK (interlocked and continuously welded corrugated armored) cable
- Non-armored and tray cable
- Class I, Division 1 – MC-HL, TC-ER-HL, ITC-HL with LSC or TSC compound
- Class I, Division 2 – MC, MC-HL, TC, TC-ER-HL, PLTC, PLTC-ER, ITC, ITC-ER, ITC-HL with LSC or TSC compound



Design features:

- (A) **Captive sealing and back nut** – the use of retaining rings with snap-in features enables the TMCX to retain all of the components in the entry end of the gland
- (B) **Integral union** – the design allows for a two-piece assembly gland, minimizing tightening and loosening of nuts
- (C) **Red anodized nut** – this hard-wearing, permanent, consistent coating is standard on all units
- (D) **Anti-rotation feature** – for single tool assembly; the splined shaft ensures that the two assemblies lock together and do not rotate during assembly
- (E) **Barrier compounds** – Chico LiquidSeal or standard TSC epoxy compound options allow for rapid curing and assembly in any orientation
- (F) **Conical compound chamber** – ensures that double the misalignment can be accepted without the risk of binding
- (G) **Captive garter spring** – copper flashed stainless steel ensures good connectivity, strength and corrosion resistance
- (H) **NPT and ISO threads** – entire range of cable glands are available with either NPT or metric threads in all materials



Certifications and compliances:

- Class I, Division 1, Groups A, B, C, D
- Class II, Groups E, F, G
- Class III
- Class I, Zone 1, Group IIC
- NEMA 4X - ½" to 4" (TMCX050 0 to TMCX400 2)
- NEMA 6P - ½" to 1¼" (TMCX050 0 to TMCX125 1)
- UL/cULus Listed - File No. E122485

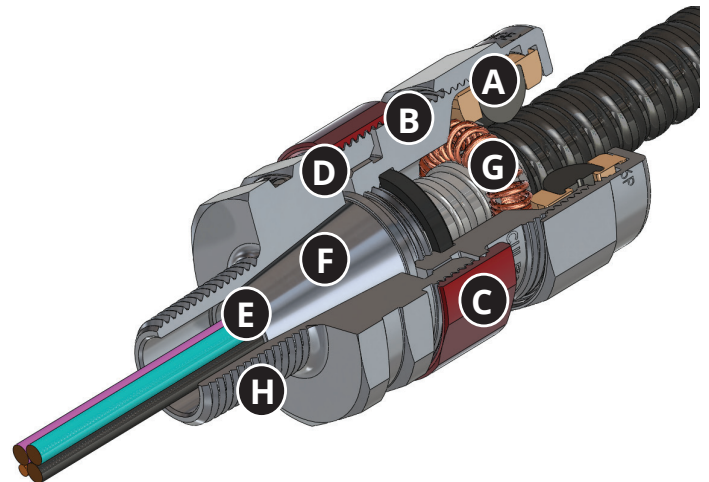

Ordering information

Multiple cable ranges per hub size for simplified selection

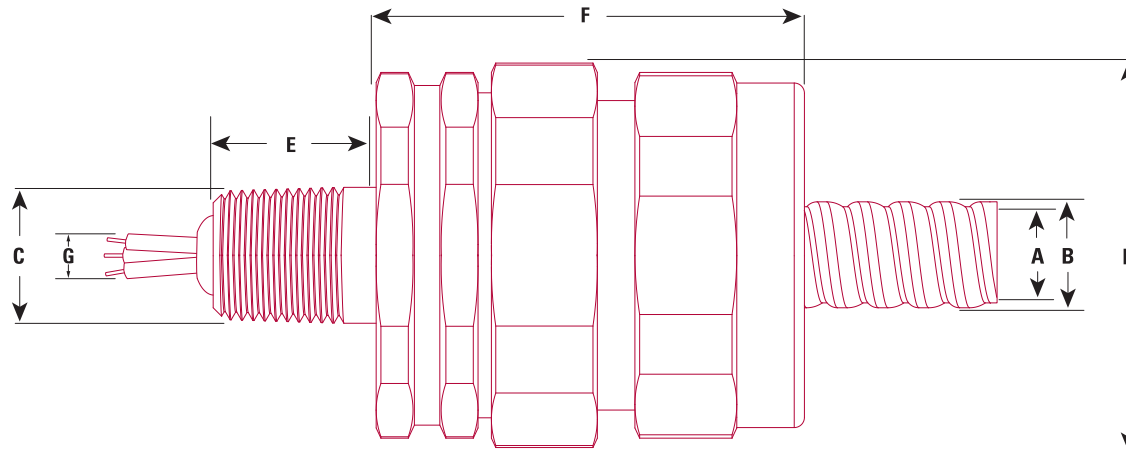

Entry thread (C)	NPT part number	Entry thread (C) (metric option)	Metric part number	Over cond. O.D. max. inches† (G)	(A) Armour O.D.		(B) Cable O.D.†		Across corners (D) in. (mm)	Thread length NPT (E) (metric mm.)	Length (F) in. (mm)
					Min. in. (mm)	Max. in. (mm)	Min. in. (mm)	Max. in. (mm)			
½"	TMCX050 0	M20	TMCXM20 0	0.480	0.36 (9.14)	0.66 (16.76)	0.45 (11.43) ‡	0.70 (17.78)	1.44 (36.51)	0.89 (22.61)	2.93 (74.42)
½"	TMCX050 1	M20	TMCXM20 1	0.480	0.40 (10.16)	0.86 (21.84)	0.49 (12.45)	0.90 (22.86)	1.75 (44.45)	1.00 (25.40)	3.05 (77.47)
½"	TMCX050 2	M20	TMCXM20 2	0.480	0.56 (14.22)	1.14 (28.96)	0.65 (16.51)	1.18 (29.97)	2.25 (57.15)	1.00 (25.40)	3.18 (80.77)
¾"	TMCX075 0	M25	TMCXM25 0	0.713	0.36 (9.14)	0.66 (16.76)	0.45 (11.43) ‡	0.70 (17.78)	1.63 (41.28)	0.90 (22.86)	2.93 (74.42)
¾"	TMCX075 1	M25	TMCXM25 1	0.713	0.40 (10.16)	0.86 (21.84)	0.49 (12.45)	0.90 (22.86)	1.75 (44.45)	1.00 (25.40)	3.05 (77.47)
¾"	TMCX075 2	M25	TMCXM25 2	0.713	0.56 (14.22)	1.14 (28.96)	0.65 (16.51)	1.18 (29.97)	2.25 (57.15)	1.00 (25.40)	3.18 (80.77)
1"	TMCX100 0	M32	TMCXM32 0	0.713	0.40 (10.16)	0.86 (21.84)	0.49 (12.45) ‡	0.90 (22.86)	1.75 (44.45)	1.08 (27.40)	3.13 (79.50)
1"	TMCX100 1	M32	TMCXM32 1	0.939	0.56 (14.22)	1.14 (28.96)	0.65 (16.51)	1.18 (29.97)	2.25 (57.15)	1.08 (27.40)	3.18 (80.77)
1"	TMCX100 2	M32	TMCXM32 2	0.939	0.78 (19.81)	1.35 (34.29)	0.87 (22.10)	1.39 (35.31)	2.56 (65.02)	1.08 (27.40)	3.30 (83.82)
1¼"	TMCX125 1	M40	TMCXM40 1	1.172	0.78 (19.81)	1.35 (34.29)	0.87 (22.10)	1.39 (35.31)	2.56 (65.02)	1.08 (27.40)	3.30 (83.82)
1¼"	TMCX125 2	M40	TMCXM40 2	1.150	0.94 (23.87)	1.67 (42.41)	1.03 (26.16)	1.65 (41.91)	3.73 (94.74)	1.25 (31.75)	4.71 (119.63)
1½"	TMCX150 1	M50	TMCXM50 1	1.370	0.94 (23.87)	1.67 (42.41)	1.03 (26.16)	1.65 (41.91)	3.73 (94.74)	1.25 (31.75)	4.71 (119.63)
1½"	TMCX150 2	M50	TMCXM50 2	1.370	1.28 (32.51)	1.97 (50.03)	1.53 (38.86)	2.07 (52.58)	4.11 (104.39)	1.25 (31.75)	4.71 (119.63)
2"	TMCX200 1	M63	TMCXM63 1	1.760	1.28 (32.51)	1.97 (50.03)	1.53 (38.86)	2.07 (52.58)	4.11 (104.39)	1.25 (31.75)	4.71 (119.63)
2"	TMCX200 2	M63	TMCXM63 2	1.760	1.67 (42.41)	2.62 (66.54)	1.81 (45.97)	2.72 (69.09)	4.98 (126.49)	1.25 (31.75)	5.63 (143.00)
2½"	TMCX250 1	M75	TMCXM75 1	2.140	1.67 (42.41)	2.62 (66.54)	1.81 (45.97)	2.72 (69.09)	4.98 (126.49)	1.81 (45.97)	5.63 (143.00)
2½"	TMCX250 2	M75	TMCXM75 2	2.140	2.11 (53.59)	2.95 (74.93)	2.34 (59.44)	3.13 (79.50)	5.61 (142.49)	1.81 (45.97)	5.80 (147.32)
3"	TMCX300 1	M90	TMCXM90 1	2.690	2.11 (53.59)	2.95 (74.93)	2.34 (59.44)	3.13 (79.50)	5.61 (142.49)	1.81 (45.97)	5.80 (147.32)
3"	TMCX300 2	M90	TMCXM90 2	2.690	2.45 (62.23)	3.39 (86.10)	2.68 (68.07)	3.61 (91.69)	6.23 (158.24)	1.81 (45.97)	6.26 (159.00)
3½"	TMCX350 1	M110	TMCXM110 1	3.130	2.45 (62.23)	3.39 (86.10)	2.68 (68.07)	3.61 (91.69)	6.23 (158.24)	1.94 (49.28)	6.26 (159.00)
3½"	TMCX350 2	M110	TMCXM110 2	3.570	3.05 (77.47)	4.22 (107.18)	3.13 (79.50)	3.97 (100.84)	6.73 (170.94)	1.94 (49.28)	6.52 (165.61)
4"	TMCX400 1	-	-	3.130	2.45 (62.23)	3.39 (86.10)	2.68 (68.07)	3.61 (91.69)	6.23 (158.24)	2.00 (50.80)	6.26 (159.00)
4"	TMCX400 2	-	-	3.570	3.05 (77.47)	4.22 (107.18)	3.13 (79.50)	3.97 (100.84)	6.73 (170.94)	2.00 (50.80)	6.52 (165.61)

*All dimensions in inches; metric millimeters shown in parenthesis.

†When making your cable gland selection based on cable O.D., be sure to also observe the over conductors O.D. dimension.

‡Minimum cable O.D. for CSA certification is 0.49 (12.45) for TMCX050 0 and TMCX075 0; 0.57 (14.48) for TMCX100 0.

Ordering information

Part number example

TMCX0501NPL

Terminator II TMCX, 1/2" hub size, sealing range 1, nickel-plated brass, Chico LiquidSeal sealing compound

TMCX

050

1

NP

L

Hub size

NPT	Hub (in.)	Metric	Hub (mm.)
050	1/2"	M20	20
075	3/4"	M25	25
100	1"	M32	32
125	1-1/4"	M40	40
150	1-1/2"	M50	50
200	2"	M63	63
250	2-1/2"	M75	75
300	3"	M90	90
350	3-1/2"	M110	110
400	4"	-	-

Material

BLANK	Aluminum
SS	316 Stainless steel
NP	Nickel-plated brass

Compound type

BLANK	TSC
L	Liquid

Cable sealing range

Hub size code	Thread	Sealing range code	Standard cable sealing range
050	1/2" NPT	0	0.45" - 0.70"
		1	0.49" - 0.90"
		2	0.65" - 1.18"
075	3/4" NPT	0	0.45" - 0.70"
		1	0.49" - 0.90"
		2	0.65" - 1.18"
100	1" NPT	0	0.49" - 0.90"
		1	0.65" - 1.18"
		2	0.87" - 1.39"
125	1-1/4" NPT	1	0.87" - 1.39"
		2	1.03" - 1.71"
		150	1-1/2" NPT
2	1.42" - 2.07"		
200	2" NPT		
		2	1.81" - 2.72"
		250	2-1/2" NPT
2	2.24" - 3.28"		
300	3" NPT		
		2	2.62" - 3.78"
		350	3-1/2" NPT
2	3.11" - 4.28"		
400	4" NPT		
		2	3.11" - 4.28"

Hub size code	Thread	Sealing range code	Metric cable sealing range
M20	M20 ISO	0	11.4 mm - 17.8 mm
		1	12.4 mm - 22.8 mm
		2	16.5 mm - 29.9 mm
M25	M25 ISO	0	11.4 mm - 17.8 mm
		1	12.4 mm - 22.8 mm
		2	16.5 mm - 29.9 mm
M32	M32 ISO	0	12.4 mm - 22.8 mm
		1	16.5 mm - 29.9 mm
		2	22.0 mm - 35.3 mm
M40	M40 ISO	1	22.0 mm - 35.3 mm
		2	26.1 mm - 43.4 mm
		M50	M50 ISO
2	36.0 mm - 52.7 mm		
M63	M63 ISO		
		2	45.9 mm - 69.0 mm
		M75	M75 ISO
2	56.8 mm - 83.3 mm		
M90	M90 ISO		
		2	66.5 mm - 96.0 mm
		M110	M110 ISO
2	78.9 mm - 108.7 mm		

Barrier compounds

Chico LiquidSeal

- Mixing time: 2 minutes
 - Application: pour/gun
 - Gel time: 15-30 minutes*
 - Full cure/return to service time: 2 hours*
 - Available for installation in vertical position
 - Integral dam means no packing or taping to prevent liquid leakage
- *At 20°C ambient temperature.



Part number	Size (ml.)	Standard carton quantity
LSC 10	10 ml.	10
LSC 20	20 ml.	10
LSC 75	75 ml.	5

Chico LiquidSeal 200 ml. cartridge

- Easily and quickly pour multiple glands
 - Self-mixing nozzles
 - Gel time: 15-30 minutes*
 - Full cure/return to service time: 2 hours*
 - Can be stored between uses
 - ½" to 1¼" in aluminum TMCX II now available bulk packed without compound
 - Can be stored between uses
- *At 20°C ambient temperature.



Applicator gun not included.

Part number	Description	Standard carton quantity
LSC200CART	200 ml. liquid compound cartridge and three (3) mixing nozzles	1
LSCTIP	Replacement mixing nozzles	5

Bulk pack glands

Part number	Description	Standard carton quantity
TMCX050 0 BULK	½" cable glands without compound	20
TMCX075 0 BULK	¾" cable glands without compound	15
TMCX100 0 BULK	1" cable glands without compound	15
TMCX050 1 BULK	½" cable glands without compound	20
TMCX075 1 BULK	¾" cable glands without compound	15
TMCX100 1 BULK	1" cable glands without compound	10
TMCX125 1 BULK	1¼" cable glands without compound	10

TSC epoxy compound

- Mixing time: 5 minutes
- Application: by hand
- Full cure time: 24 hours
- Available for installation in any orientation

Part number	Tube size (oz.)	Standard carton quantity
TSC05	0.5 oz.	10
TSC1	1.0 oz.	10
TSC4	4.0 oz.	5





Cable tray systems

As an industry leader in cable tray, Eaton offers one of the widest ranges of B-Line series cable management solutions available in the market today. With unmatched quality and service, we offer a variety of styles, materials and finishes available to support virtually any commercial, data center and industrial cable management application requirement.

- Series 2 to 5 imperial cable tray systems
- Metric cable ladder systems
- Cable channel systems
- Cable bus systems
- Wire basket tray
- Technical and engineering services

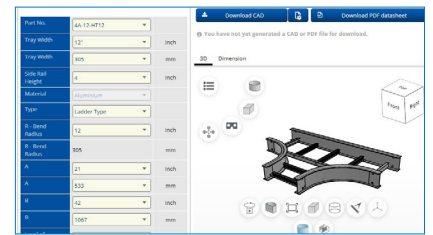
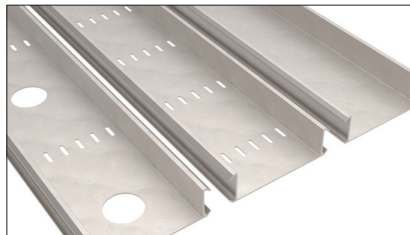
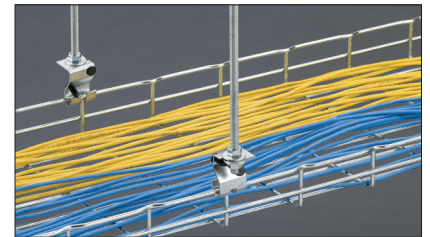

Learn how Eaton's B-Line series cable tray can help you achieve a total lower installed cost on your next project.



Eaton.com/cabletray

U.S. (global headquarters):

**Eaton's Global Energy
Infrastructure Solutions**

**Crouse-Hinds series and
B-Line series products**

1201 Wolf Street
Syracuse, NY 13208

(866) 764-5454
FAX: (315) 477-5179
FAX Orders Only:
(866) 653-0640

crousecustomerctr@eaton.com

For more information:

If further assistance is
required, please contact
an authorized Eaton
Distributor, Sales Office,
or Customer Service
Department.

Canada

Toll Free: 800-265-0502
FAX: (800) 263-9504
FAX Orders only: (866) 653-0645

Mexico/Latin America/Caribbean

52-555-804-4000
FAX: 52-555-804-4020
ventascentromex@eaton.com

Europe (Germany)

49 (0) 6271 806-500
49 (0) 6271 806-476
info-ex@eaton.com

Eaton Middle East

9714-8066100
FAX: 9714-8894813
CHBL-ME@eaton.com

Singapore

65-6645-9888
FAX: 65-6297-4819
chsi-sales@eaton.com

China

86-21-2899-3600
FAX: 86-21-2899-4055
echsales@eaton.com

Korea

82-2-3484-6783
82-2-3484-6778
ECHKsales@eaton.com

Australia

61-2-8787-2777
FAX: 61-2-9609-2342
Crousehindsanz@eaton.com

India

91-124-4683888
FAX: 91-124-4683899
cchindia@eaton.com

For additional information,
visit [Eaton.com](https://www.eaton.com)