

M-14457

1

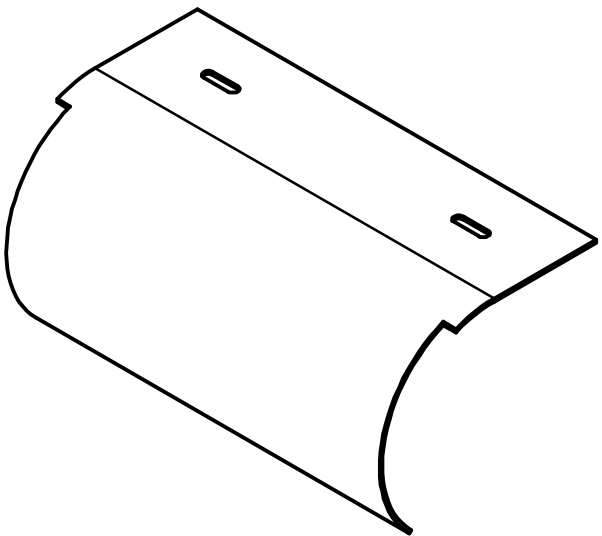
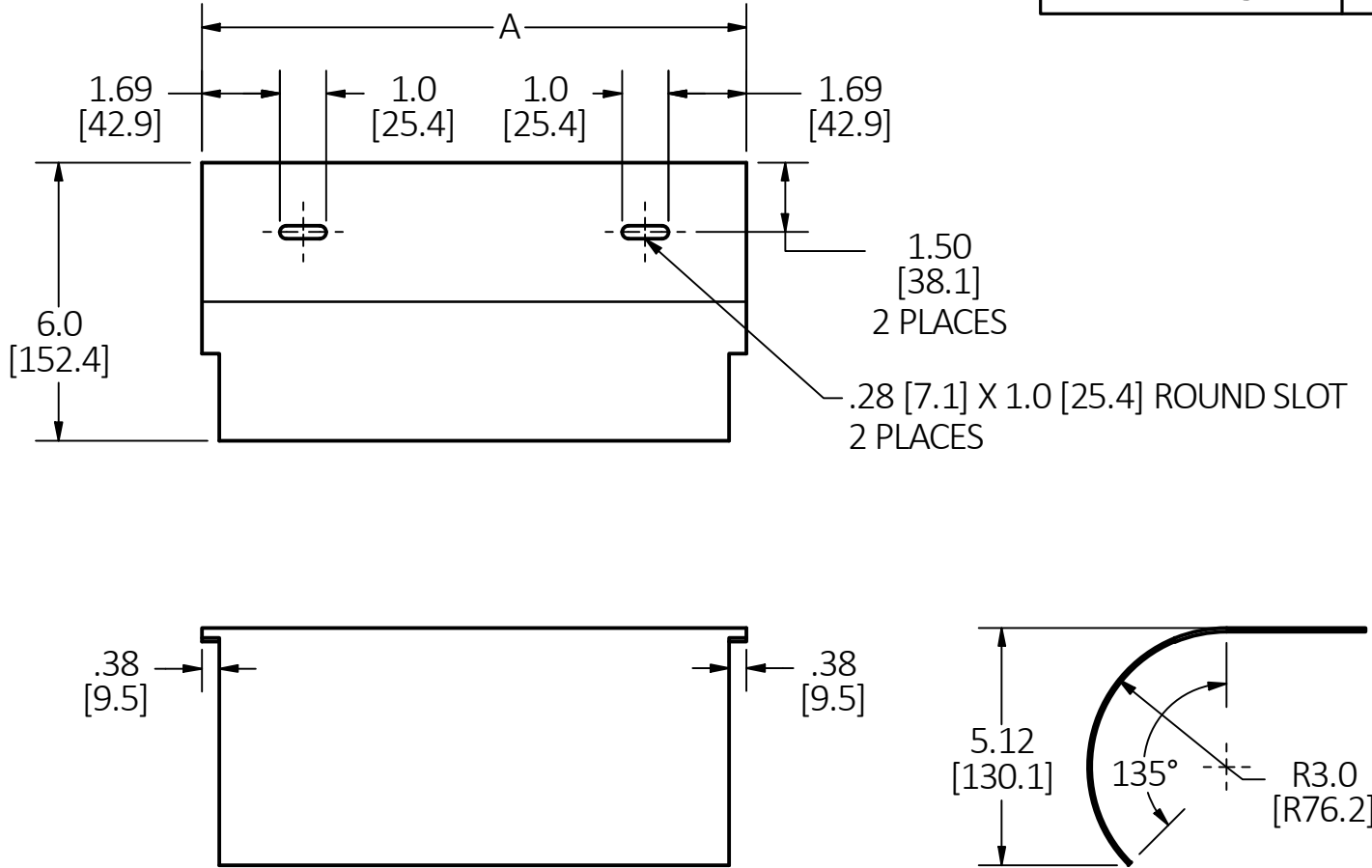

CATALOG NUMBER	TRAY WIDTH (in [mm])	A (in [mm])
LCD12	12 [304.8]	11.75 [298.5]
LCD18	18 [457.2]	17.75 [450.9]
LCD24	24 [609.6]	23.75 [603.3]

- NOTES:
1. ALL DIMENSIONS ARE IN INCHES AND [MILLIMETERS].
 2. PRODUCT IS cULus CLASSIFIED.
 3. CLASS 1 FITTING.
 4. SUPPLIED WITH (1) DROPOUT PLATE, FASTENERS: (2) Ø1/4" X 1-1/2" LONG SCREWS, (2) Ø1/4" FLANGED HEX NUTS & (2) 1/4" ROUND FENDER WASHERS.
 5. INSTALL IN ACCORDANCE WITH NEMA STANDARD VE-2 "CABLE TRAY INSTALLATION GUIDELINES".

LIST OF PARTS

DESCRIPTION	MATERIAL	FINISH
DROPOUT PLATE	ALUMINUM	
SCREWS	STAINLESS STEEL	
NUTS	STAINLESS STEEL	
WASHERS	STAINLESS STEEL	

1	RELEASED PER DCN211102014008	AD	11/2/21
REV	DESCRIPTION	APP	DATE

THE DESIGN AND DIMENSIONS OF THE PRODUCT SHOWN ON THIS DRAWING ARE SUBJECT TO CHANGE WITHOUT NOTICE. DIMENSIONS ARE IN INCHES [mm].

TITLE
CABLE DROPOUT,
LADDER TRAY

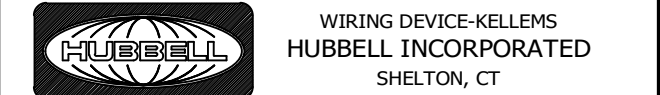

TOLERANCES UNLESS OTHERWISE SPECIFIED .XX = ± .01 .XXX = ± .005 ANGLE TOL. ±2°	DR. BY AD	SCALE NONE
CHK. BY SBW	DATE 10/13/21	