

VF14, AF14 and VAFT C and Z Purlin Clips

Features

1. Easily installs from floor with installation tool (VAFT).
2. No scaffolding required.
3. Supports wire or rod from bar joist (VF14) or Z-purlin (AF14).
4. One fastener fits flanges 1/16" to 1/4".
5. New design for increased applications.
6. Made from lightweight high impact plastic to increase durability.

| Part Number | Article Number | Fig. | Description | Rod Size (in. [mm]) | F (lbs. [N]) |
|-------------|----------------|------|--|---------------------|--------------|
| VF14 | 179850 | 1 | C-Purlin Vertical Flange Clip | N/A | 160 [712] |
| AF14 | 179860 | 2 | Z-Purlin Angle Flange Clip | | 100 [445] |
| VAFT | 190330 | 3 | VF14 & AF14 Purlin Installation Tool | | N/A |
| PW2 | 175590 | 4 | C-Purlin Clip with 0.267 [6.8mm] Hole | | 157 [700] |
| PW2CT | 175690 | 5 | C-Purlin Clip with Cable Tie Holder | | |
| PW2M6MA | 175730 | 6 | C-Purlin Clip with Plain Rod Holder | 0.24 [M6] | 135 [600] |
| PW2M8MA | 175740 | | | 0.31 [M8] | 157 [700] |
| PW2M10MA | 175750 | | | 0.39 [M10] | |
| PW2M6TIN | 175600 | 7 | C-Purlin Clip with Threaded Rod Holder | 0.24 [M6] | 157 [700] |
| PW2M8TIN | 175610 | | | 0.31 [M8] | |
| PW2M10TIN | 175620 | | | 0.39 [M10] | |
| PW2T10IN | 175630 | | C-Purlin Clip with Plain Rod Holder | | |

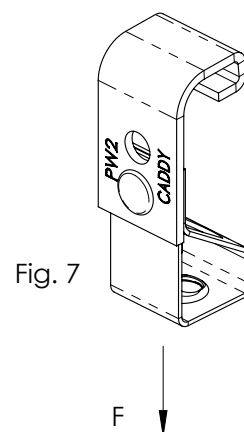
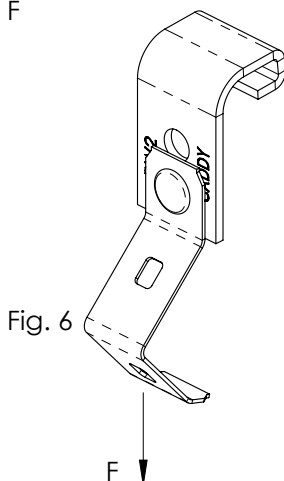
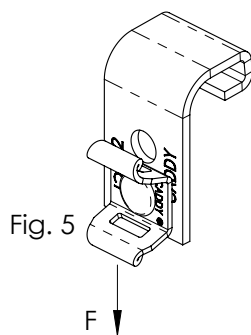
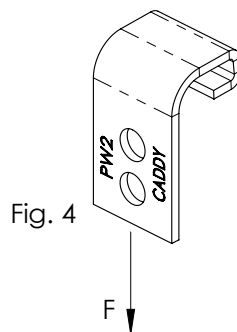
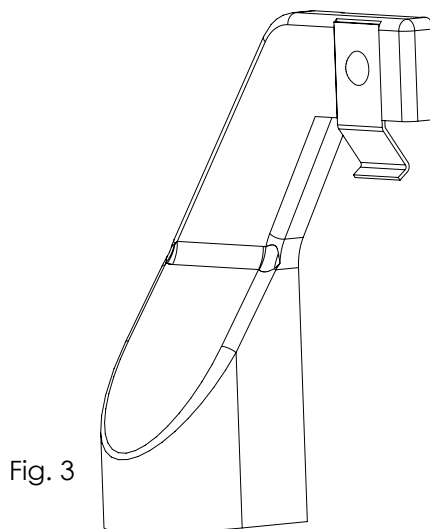
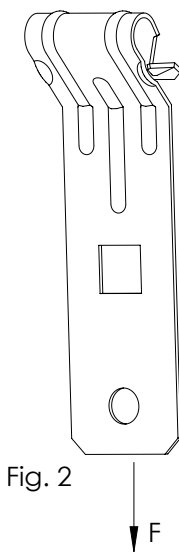
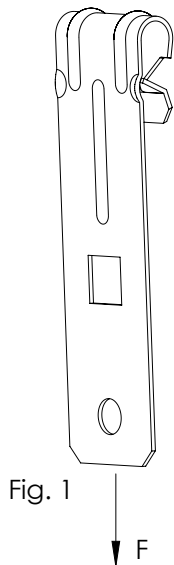

WARNING:

1. nVent products shall be installed and used only as indicated in nVent product instruction sheets and training materials. Instruction sheets are available at www.nVent.com and from your nVent customer service representative.
2. nVent products must never be used for a purpose other than the purpose for which they were designed or in a manner that exceeds specified load ratings.
3. All instructions must be completely followed to ensure proper and safe installation and performance.
4. Improper installation, misuse, misapplication or other failure to completely follow nVent's instructions and warnings may cause product malfunction, property damage, serious bodily injury and/or death, and void your warranty.
5. Products that are manufactured using spring steel components shall be used only in a non-corrosive indoor environment.
6. All pipe supports, hangers, intermediate components and structural attachments must ONLY be used as described herein and are NEVER to be used for any other purpose.

NOTE: All load ratings are for static conditions and do not account for dynamic loading such as wind, water or seismic loads, unless otherwise noted.

The customer is responsible for:

- a. Conformance to all governing codes.
- b. The integrity of structures to which the products are attached, including their capability of safely accepting the loads imposed, as evaluated by a qualified engineer.
- c. Using appropriate industry standard hardware as noted above.

SAFETY INSTRUCTIONS:

All governing codes and regulations and those required by the job site must be observed. Always use appropriate safety equipment such as eye protection, hard hat, and gloves as appropriate to the application.

nVent, nVent CADDY, nVent ERICO Cadweld, nVent ERICO Critec, nVent ERICO, nVent ERIFLEX, and nVent LENTON are owned by nVent or its global affiliates. All other trademarks are the property of their respective owners. nVent reserves the right to change specifications without prior notice.

TECHNICAL SUPPORT:
www.nVent.com

CFS329_C

1 OF 2

© 2001-2019 nVent All Rights Reserved



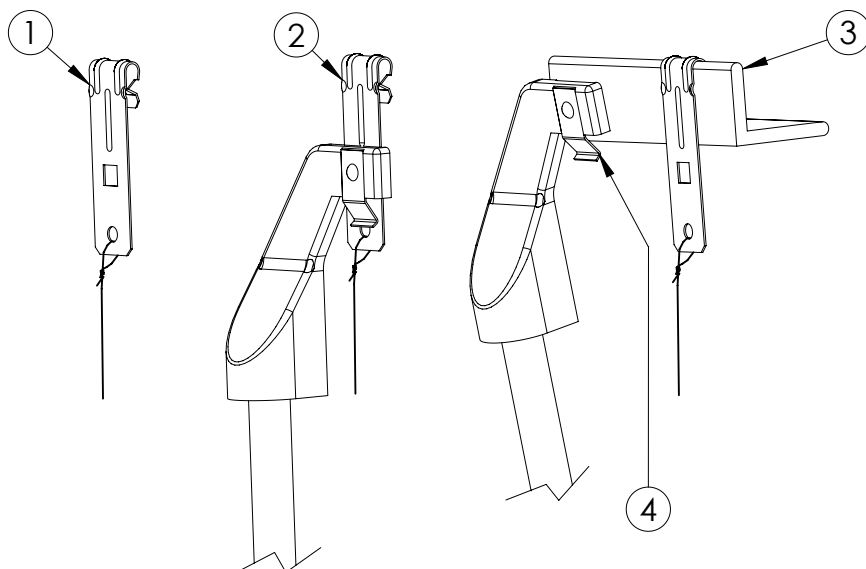

1. Tie wire to clip.
2. Install clip to installation tool.
3. Raise tool and fastener assembly above flange. Place fastener against flange and pull straight down. Engaging fastener to flange.
4. To disengage tool, lift up after fastener has been engaged.

Height adjustment for VAFT:

1. To obtain desired installation height use 1/2" rigid conduit.
2. Screw threaded end of conduit into base of installation tool (VAFT).
3. Cut to desired length.

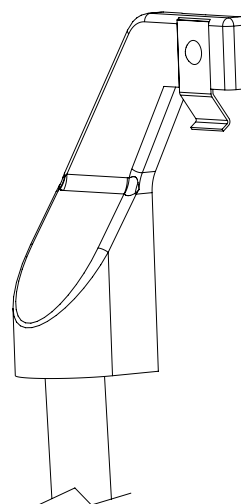
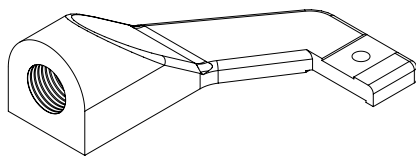

See catalog for other applications.

Can be used with pre-assembled combinations:

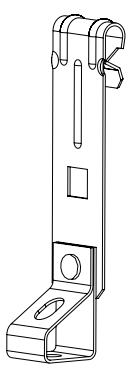

Threaded Rod

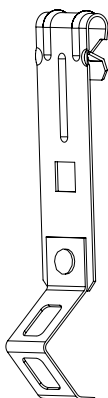

Plain Rod

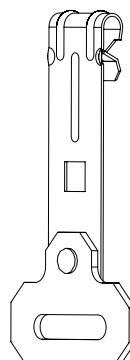

Strap Hangers

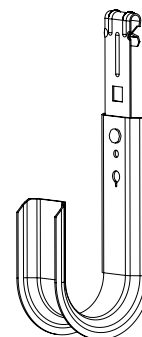

J-Hooks