

For use with Eaton's Crouse-Hinds EDS/EDSC back boxes (single- and two-gang) and EDSCM modular control device bodies (up to nine-gang maximum). These bodies are to be ordered separately from the DSD-TS covers.

Applications:

- Provides automatic shut-off for fans, heaters, pumps, lights and other energy-consuming loads in Class I and Class II hazardous areas

Features:

- Spring wound, mechanical timer switch
- Copper-free aluminum covers

Certifications and compliances:

- CSA certified per file LR5169
- Class I, Divisions 1 & 2, Groups C, D
- Class II, Divisions 1 & 2, Groups E, F, G
- Class III

**Note:** Suitable for use in Zone 1 and Zone 2 classified areas (gas groups IIB and IIA) as per Canadian Electrical Code, Part I, Section 18-100(a).



Electrical ratings:

- 1 HP, 125 VAC max.
- 2 HP, 250 VAC max.
- 7A Tungsten, 125 VAC max.
- 20A resistive 125 VAC max.
- 10A resistive 250 VAC max.
- 10A resistive 277 VAC max.

Dimensions (in inches):

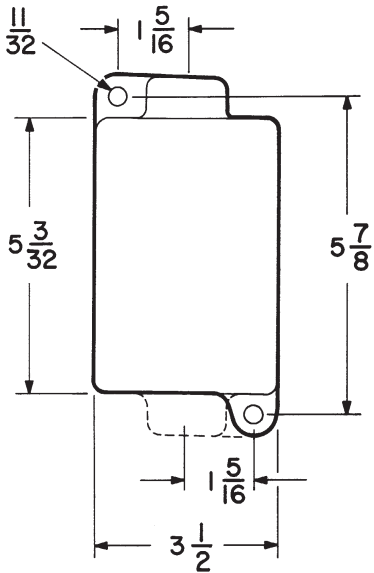

**Note:** Depth is 5.5" from front of switch to back of box.

Ordering information:

Part number example  
DSDTS11M15SA

