

Product data sheet

Specifications

SQUARE D



Safety switch, heavy duty, fused, viewing window, Type 4X, 600V, 100A, 3 pole, ground lugs

VH363DSGL

Product availability : Stock - Normally stocked in distribution facility

Main

Product	Single Throw Safety Switch
Duty Rating	Heavy duty
Device Application	Heavy application
Disconnect Type	Fusible disconnect
Factory Installed Neutral	Field installed kit available
Number of Poles	3
Current Rating	100 A
Voltage Rating	600 V AC/DC
Enclosure Rating	NEMA 4X stainless steel 304
Motor power hp	25 hp at 480 V AC 50-60 Hz for 3 phase motors 60 hp at 480 V AC 50-60 Hz for 3 phase motors 30 hp at 600 V AC 50-60 Hz for 3 phase motors 100 hp at 600 V AC 50-60 Hz for 3 phase motors 50 hp at 600 V DC

Complementary

Short-circuit current	10 kA for H, K, J or R without fuse rejection clips 200 kA for R with fuse rejection clips 200 kA for J
Fuse type	H or K R or J
Mounting Type	Surface
Electrical Connection	Lugs
Wiring configuration	3-wire
Wire Size	AWG 12...AWG 1/0 aluminium AWG 14...AWG 1/0 copper
Tightening torque	50 lbf.in (5.65 N.m) (AWG 1...AWG 3/0) 45 lbf.in (5.08 N.m) (AWG 6...AWG 4) 40 lbf.in (4.52 N.m) 0.01 in ² (8.367 mm ²) (AWG 8) 35 lbf.in (3.95 N.m) 0.00...0.01 in ² (2.06...5.261 mm ²) (AWG 14...AWG 10)
Depth	7.2 in (182.88 mm)
Width	9.336 in (237.13 mm)
Height	20.73 in (526.54 mm)
Net Weight	22.99 lb(US) (10.43 kg)
Grounding Kit	Factory installation

Service Entrance	Suitable service entrance for USA Suitable service entrance for Mexico
------------------	---

Environment

Certifications	UL listed file E2875
----------------	----------------------

Ordering and shipping details

Category	00010-H&HU SW,2&3P,N4,SS,30-200A
Discount Schedule	DE1
GTIN	3606485894232
Returnability	Yes
Country of origin	US

Packing Units

Unit Type of Package 1	PCE
Number of Units in Package 1	1
Package 1 Height	7.50 in (19.05 cm)
Package 1 Width	11.37 in (28.892 cm)
Package 1 Length	22.62 in (57.467 cm)
Package 1 Weight	24.03 lb(US) (10.9 kg)

Offer Sustainability

California proposition 65	WARNING: This product can expose you to chemicals including: Lead and lead compounds, which is known to the State of California to cause cancer and birth defects or other reproductive harm. For more information go to www.P65Warnings.ca.gov
EU RoHS Directive	Under investigation

Dimensions

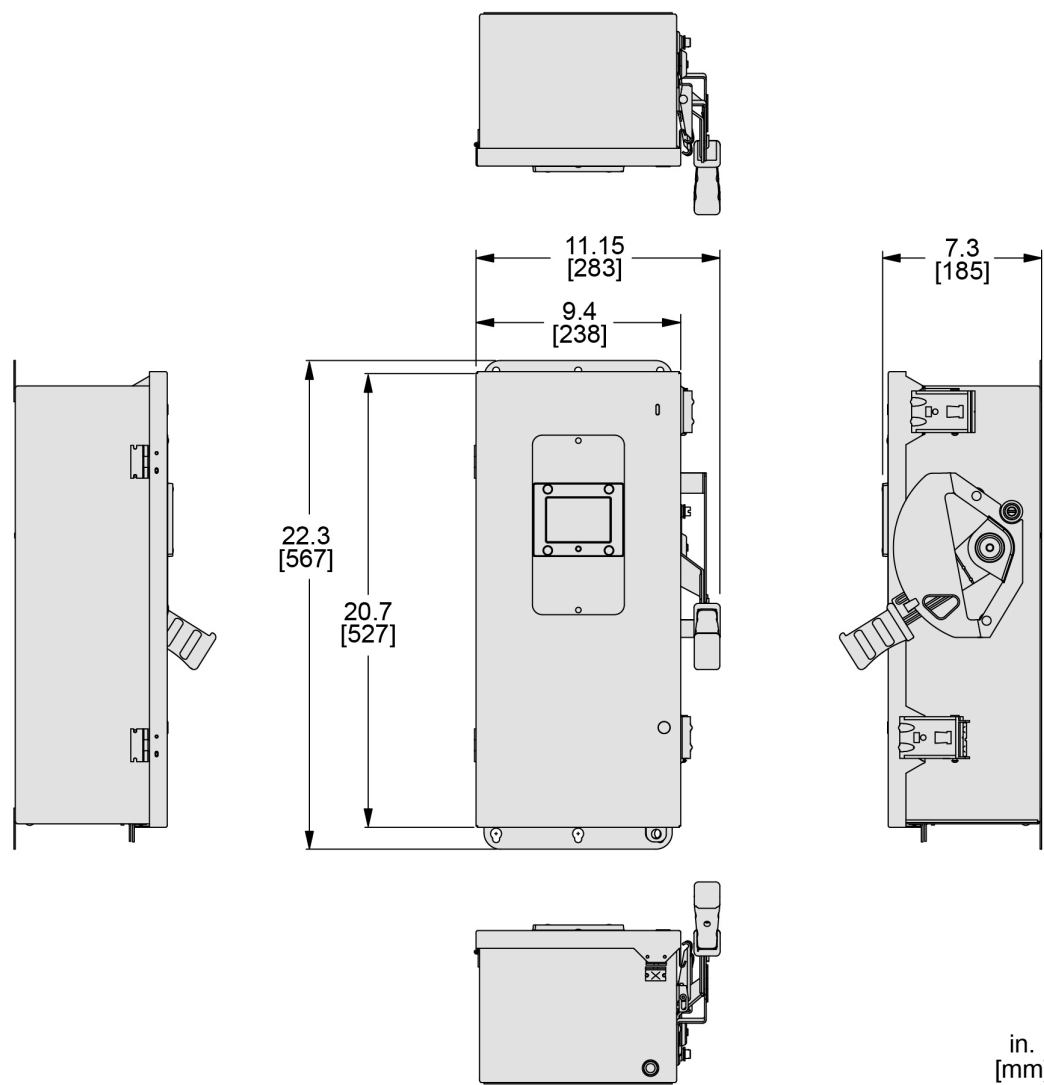

ALL DIMENSIONS ARE APPROXIMATE.
REFER TO TECHNICAL DRAWINGS AND DOCUMENTATION FOR COMPLETE INFORMATION.

Wiring Diagram

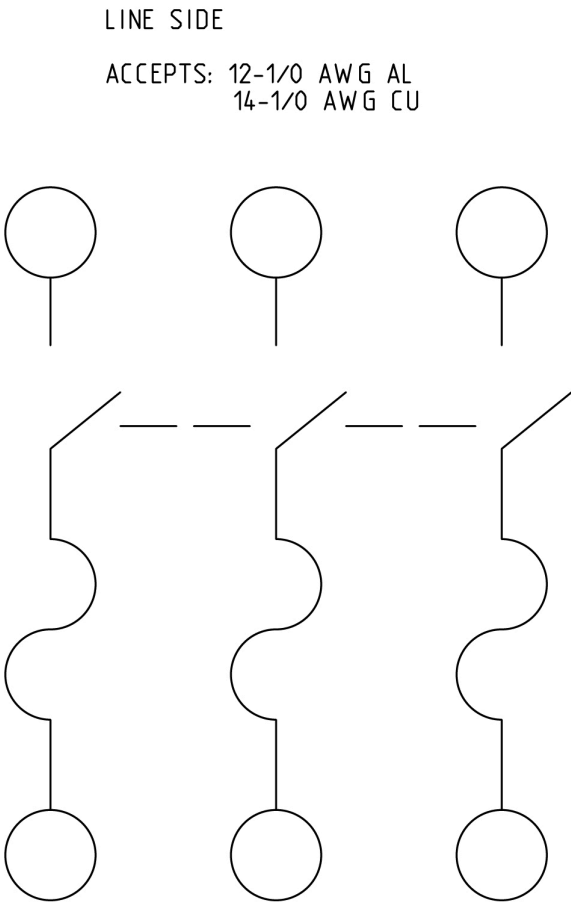

REFER TO TECHNICAL DRAWINGS AND DOCUMENTATION FOR COMPLETE INFORMATION.

Recommended replacement(s)