

# X34 Field-Adjustable Floodlight

**RAB****X34XS****X34S  
X34S/RGB****X34M  
X34M/RGB****X34L  
X34L/RGB****X34XL & X34XXL  
X34XXL/RGB**

## X34 Floodlight with selectable power & CCT

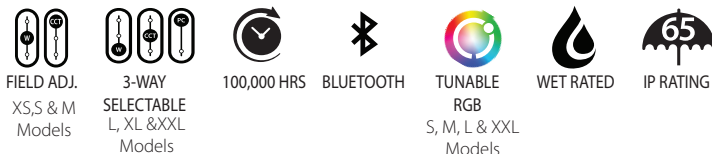

PROJECT: \_\_\_\_\_

DATE: \_\_\_\_\_

TYPE: \_\_\_\_\_

PREPARED BY: \_\_\_\_\_



\* XS, S &amp; M Models

\*\* L, XL &amp; XXL Models

### KEY FEATURES

- Ultra-economy floodlights with selectable **power** and **CCT**
- Available models & wattages:
  - X34XS : 16/13/10W
  - X34S: 35/25/20W
  - X34M: 65/55/45W
  - X34L: 90/80/70W
  - X34XL: 130/110/95W
  - X34XXL: 160/140/120W
- Selectable CCT: 3000/4000/5000K
- RGBW models also available with static wattages:
  - X34S: 30W, X34M: 60W, X34L: 90W & X34XXL: 160W
- RGBW models with tunable white 2500-6500K CCT, 16+ million colors to select
- **Knuckle mount** on X34XS, X34XS & X34M models and **Slipfitter** or **Trunnion** option for X34L, X34XL & X34XXL models
- Suitable for **wet** locations
- 120 or 277V, non-dimming driver for X34XS, X34S & X34M models. The driver includes wiring for 0-10V dimming for X34L, X34XL & X34XXL models.
- **5-year** limited warranty

## TECHNICAL SPECIFICATIONS

### COMPLIANCE

#### UL Listed

Suitable for wet locations

#### IP Rating

Ingress protection rating of IP65 for dust and water

#### DLC Listed (X34XS, X34S & X34M)

This product is on the Design Lights Consortium (DLC) Qualified Products List and is eligible for rebates from DLC Member Utilities. Designed to meet DLC 5.1 requirements.

#### DLC Listed (X34L, X34XL & X34XXL)

This product is listed by Design Lights Consortium (DLC) as an ultra-efficient premium product that qualifies for the highest tier of rebates from DLC Member Utilities. Designed to meet DLC 5.1 requirements.

| DLC STANDARD |                | DLC PREMIUM |                |
|--------------|----------------|-------------|----------------|
| Model#       | DLC Product ID | Model#      | DLC Product ID |
| X34XS        | S-P1Q64R       | X34L        | S-EZPO0W       |
| X34S         | S-T9KEIS       | X34XL       | S-2HQ7D4       |
| X34M         | S-MZAHWR       | X34XXL      | S-AOKIJL       |

### CONSTRUCTION

#### Cold Weather Starting

Minimum starting temperature is -40°C (-40°F)

#### Maximum Ambient Temperature

Suitable for use in up to 40°C (104°F)

#### Housing

Precision die-cast aluminum

#### Mounting

X34XS, X34S &amp; X34M: Knuckle Mount

X34L, X34XL &amp; X34XXL: Slipfitter (Tilt increment: 10°), Trunnion (Tilt increment 30°)

#### Lens

Tempered glass

#### Reflector

Polycarbonate for Models X34XS, X34S &amp; X34M. Polyethylene terephthalate for X34L, X34XL &amp; X34XXL.

#### Green Technology

Mercury and UV free. RoHS-compliant components.

#### Finish

Formulated for high durability and long lasting color

#### NEMA

NEMA beam spread of 7H x 7V

#### EPA

X34L: 0.9

X34XL: 1.1

X34XXL: 1.1

# X34 Field-Adjustable Floodlight



## TECHNICAL SPECIFICATIONS (CONTINUED)

### FACTORY DEFAULT

#### Selectable Wattage:

X34XS : 16/13/10W (Default 16W)  
X34S: 35/25/20W (Default 35W), X34S/RGB: Static 30W  
X34M: 65/55/45W (Default 65W), X34M/RGB: Static 60W  
X34L: 90/80/70W (Default 90W), X34L/RGB: Static 90W  
X34XL: 130/110/95W (Default 130W)  
X34XXL: 160/140/120W (Default 160W), X34XXL/RGB: Static 160W

#### CCT:

3000/4000/5000K (Default 4000K)

**RGB Models:** Tunable white: 2200K - 6500K (Default 3000K).

Adjustable using Lightcloud Blue mobile app)

16+ million RGB colors

### LED CHARACTERISTIC

#### LEDs

Long-life, high-efficacy, surface-mount LEDs

#### Color Uniformity

RAB's range of Correlated Color Temperature follows the guidelines of the American National Standards for Specifications for the Chromaticity of Solid State Lighting (SLL) Products, ANSI C78.377-2017.

#### Color Consistency

<5-step MacAdam Ellipse binning to achieve consistent fixture-to-fixture color

### ELECTRICAL

#### Drivers:

Constant Current, Class 1, 120 or 277V, 50/60 Hz

#### X34XS

16W: 120V: 0.14A, 277V: 0.06A

13W: 120V: 0.12A, 277V: 0.05A

10W: 120V: 0.08A, 277V: 0.04A

#### X34S:

35W: 120V: 0.30A, 277V: 0.13A

25W: 120V: 0.22A, 277V: 0.10A

20W: 120V: 0.18A, 277V: 0.08A

#### X34M:

65W: 120V: 0.60A, 277V: 0.24A

55W: 120V: 0.50A, 277V: 0.20A

45W: 120V: 0.37A, 277V: 0.17A

#### Drivers:

Constant Current, Class 1, 120-277V, 50/60 Hz

#### X34L:

90W: 120V: 0.78A 208V: 0.44A, 240V: 0.38A, 277V: 0.35A

80W: 120V: 0.69A 208V: 0.40A, 240V: 0.34A, 277V: 0.31A

70W: 120V: 0.59A 208V: 0.34A, 240V: 0.30A, 277V: 0.27A

#### X34XL:

130W: 120V: 1.13A 208V: 0.63A, 240V: 0.55A, 277V: 0.49A

110W: 120V: 0.98A 208V: 0.53A, 240V: 0.46A, 277V: 0.43A

95W: 120V: 0.85A 208V: 0.46A, 240V: 0.40A, 277V: 0.38A

#### X34XXL:

160W: 120V: 1.34A 208V: 0.77A, 240V: 0.67A, 277V: 0.60A

140W: 120V: 1.19A 208V: 0.68A, 240V: 0.60A, 277V: 0.52A

120W: 120V: 1.02A 208V: 0.58A, 240V: 0.50A, 277V: 0.46A

#### Drivers:

Constant Current, Class 1, 120-277V, 50/60 Hz

**X34S/RGB:** 120V: 0.25A 208V: 0.15A, 240V: 0.13A, 277V: 0.11A

**X34M/RGB:** 120V: 0.50A 208V: 0.29A, 240V: 0.25A, 277V: 0.22A

**X34L/RGB:** 120V: 0.75A 208V: 0.44A, 240V: 0.38A, 277V: 0.33A

**X34XXL/RGB:** 120V: 1.34A 208V: 0.77A, 240V: 0.67A, 277V: 0.58A

### ELECTRICAL

#### Dimming Drivers:

Driver includes dimming control wiring for 0-10V dimming system. Requires separate 0-10V DC dimming circuitry. Dims down to 10%.

*Note: Does not apply to the RGB models.*

#### Dimming Drivers (RGB)

Dimming via the Lightcloud Blue mobile app and devices

This lamp will not operate properly when connected to a standard (incandescent) dimmer or dimming control

#### Photocell:

Models X34L, X34XL & X34XXL: 120-277V selectable On/Off photocell that can be turned on and off. RGB models do not have a photocell.

#### Surge Protection:

2kV

#### THD/Power Factor:

| MODEL# | WATTAGE | THD   | PF    | THD   | PF    |
|--------|---------|-------|-------|-------|-------|
|        |         | @120V |       | @277V |       |
| X34XS  | 16W     | 14.3% | 98.2% | 16.2% | 92.9% |
|        | 13W     | 14.0% | 98.6% | 16.4% | 90.5% |
|        | 10W     | 14.6% | 98.3% | 14.8% | 87.8% |
| X34S   | 35W     | 4.3%  | 99.7% | 8.2%  | 96.2% |
|        | 25W     | 5.0%  | 99.7% | 16.8% | 91.7% |
|        | 20W     | 6.1%  | 99.4% | 20.5% | 90.6% |
| X34M   | 65W     | 3.6%  | 99.8% | 7.9%  | 96.4% |
|        | 55W     | 4.2%  | 99.8% | 12.2% | 94.8% |
|        | 45W     | 5.1%  | 99.6% | 17.2% | 92.8% |
| X34L   | 90W     | 3.9%  | 99.7% | 6.6%  | 93.9% |
|        | 80W     | 4.0%  | 99.6% | 7.9%  | 92.7% |
|        | 70W     | 4.3%  | 99.5% | 10%   | 90.9% |
| X34XL  | 130W    | 4.1%  | 99.8% | 7.2%  | 96%   |
|        | 110W    | 4.1%  | 99.8% | 7.9%  | 95.1% |
|        | 95W     | 4.0%  | 99.7% | 8.8%  | 93.9% |
| X34XXL | 160W    | 3.1%  | 99.8% | 5.9%  | 95.2% |
|        | 140W    | 3.0%  | 99.7% | 8.6%  | 93.3% |
|        | 120W    | 2.7%  | 99.6% | 10.4% | 90.7% |

| Model#   | THD   | PF    | Model#     | THD  | PF    |
|----------|-------|-------|------------|------|-------|
| X34S/RGB | 120V  |       | X34L/RGB   | 120V |       |
| @2700K   | 5.4%  | 99.8% | @2700K     | 2.0% | 99.8% |
| @3000K   | 5.4%  | 99.8% | @3000K     | 2.1% | 99.8% |
| @4000K   | 5.4%  | 99.7% | @4000K     | 2.1% | 99.8% |
| @5000K   | 5.4%  | 99.7% | @5000K     | 2.1% | 99.8% |
| @6500K   | 5.3%  | 99.7% | @6500K     | 2.1% | 99.8% |
| X34M/RGB | 120V  |       | X34XXL/RGB | 120V |       |
| @2700K   | 13.0% | 99.1% | @2700K     | 6.4% | 99.6% |
| @3000K   | 12.1% | 99.3% | @3000K     | 7.3% | 99.6% |
| @4000K   | 12.1% | 99.4% | @4000K     | 7.6% | 99.6% |
| @5000K   | 11.6% | 99.4% | @5000K     | 7.5% | 99.6% |
| @6500K   | 12.4% | 99.4% | @6500K     | 7.6% | 99.6% |

Note: All values are typical (tolerance +/- 10%)

# X34 Field-Adjustable Floodlight



## TECHNICAL SPECIFICATIONS (CONTINUED)

### LIGHTCLOUD BLUE

#### Lightcloud Blue-Enabled

Lightcloud Blue (LCB) is a Bluetooth Mesh wireless lighting control system that allows you to control RAB's various compatible devices. With RAB's patented Rapid Provisioning technology, devices can be quickly and easily commissioned for residential and large commercial applications using the Lightcloud Blue mobile app. Each device in a system can communicate with any other device, eliminating the need for a Gateway or Hub and maximizing the control system's reach.

DLC system - N1XMLOEATBA (Interior); NHCZ2BIA17L (Exterior)

Learn more at [www.lightcloud.com](http://www.lightcloud.com)

### PERFORMANCE

#### Lifespan

100,000-hour LED lifespan based on IES LM-80 results and TM-21 calculations

#### OTHER

#### Warranty

The RAB 5-year, limited warranty covers light output, driver performance and paint finish. RAB's warranty is subject to all terms and conditions found at [rablighting.com/warranty](http://rablighting.com/warranty).

## DIMENSIONS

### X34XS

Weight: 0.36 lbs

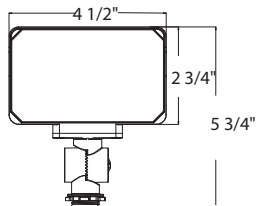

### X34S

Weight: 0.6 lbs

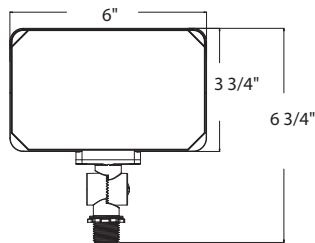

### X34S/RGB

Weight: 0.6 lbs

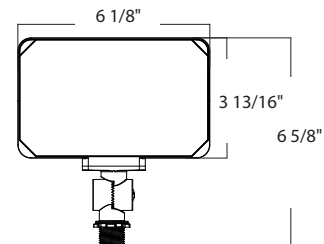

### X34M

Weight: 1.23 lbs

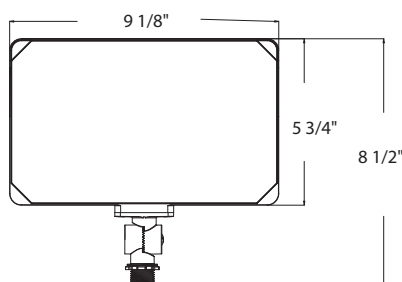

### X34M/RGB

Weight: 1.23 lbs

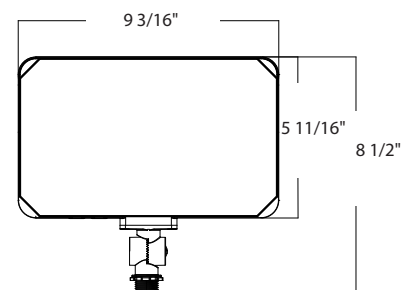

# X34 Field-Adjustable Floodlight



## DIMENSIONS

### X34L

Weight: w/Slipfitter : 6.6 lbs, w/Trunnion: 6.8 lbs

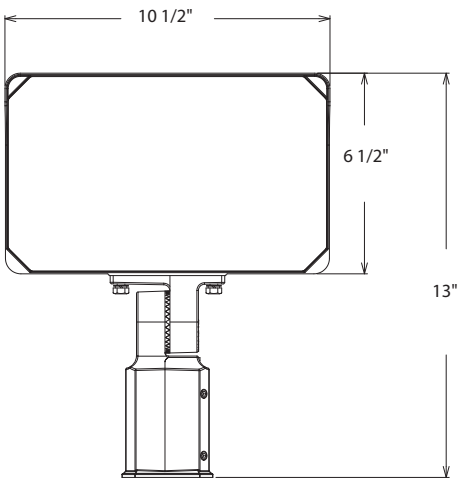

Slipfitter Mount

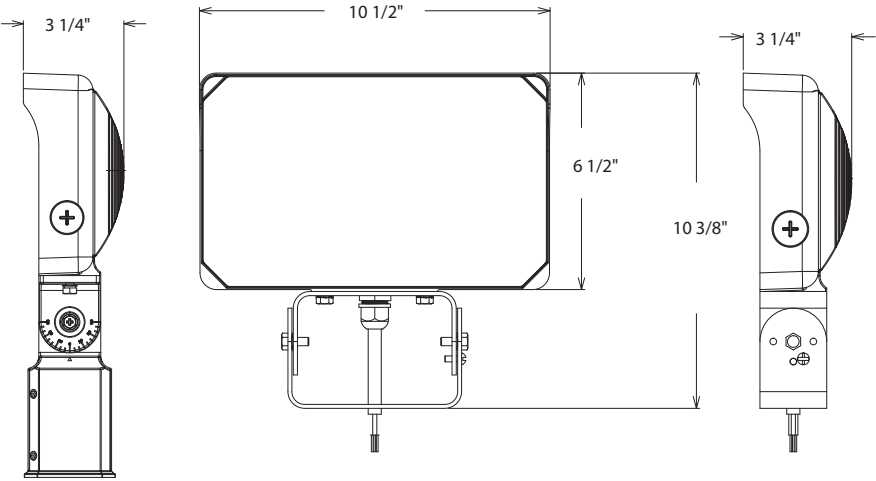

Trunnion Mount

### X34L/RGB

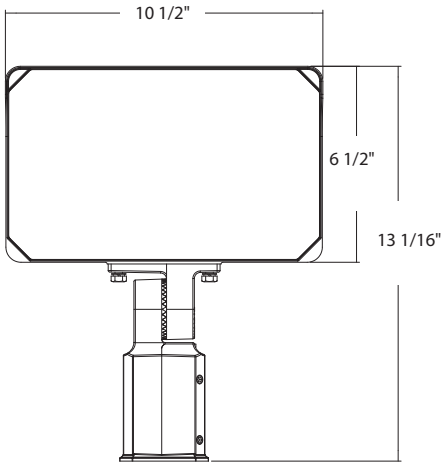

Slipfitter Mount

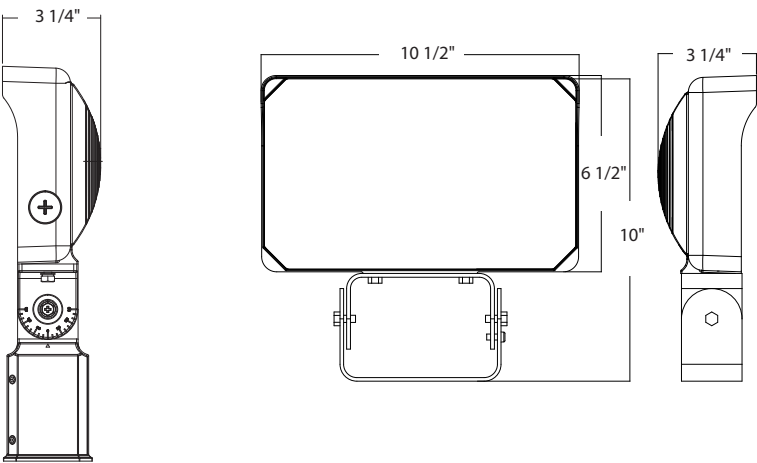

Trunnion Mount

# X34 Field-Adjustable Floodlight



## DIMENSIONS

### X34XL / X34XXL

Weight (X34XL) : w/Slipfitter: 8.1 lbs, w/Trunnion: 8.5 lbs

Weight (X34XXL) : w/Slipfitter: 8.5 lbs, w/Trunnion: 9 lbs

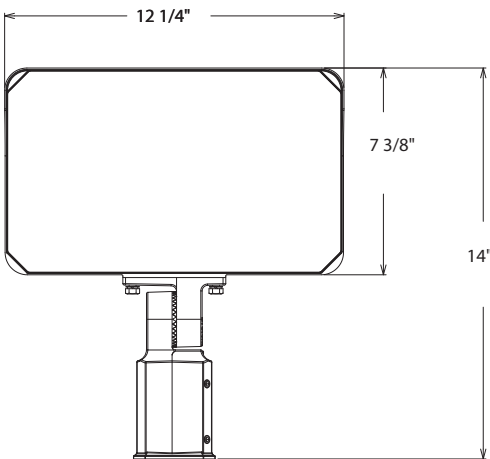

Slipfitter Mount

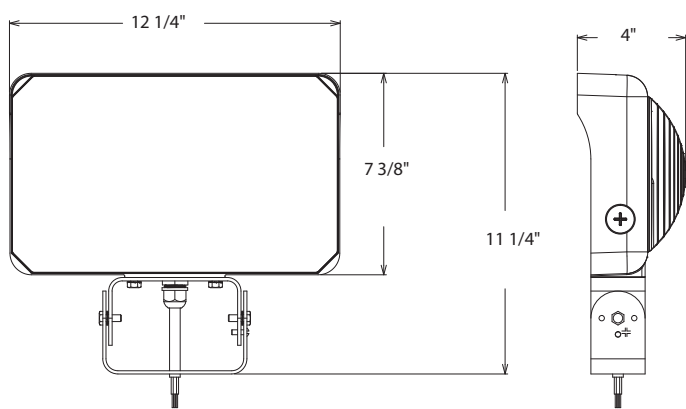

Trunnion Mount

### X34XXL/RGB

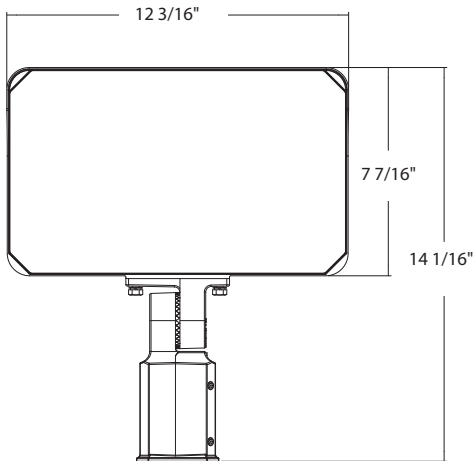

Slipfitter Mount

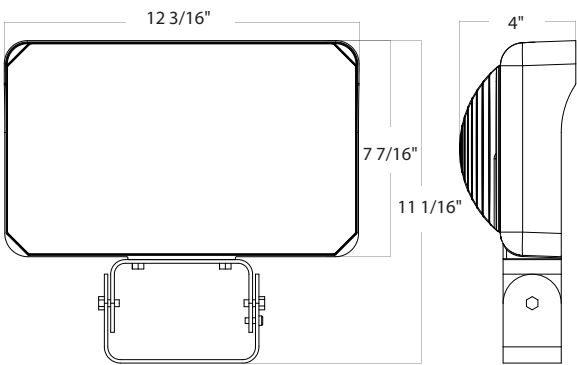

Trunnion Mount

# X34 Field-Adjustable Floodlight



## PERFORMANCE

| X34XS           | 3000K       | 4000K | 5000K | 3000K | 4000K | 5000K | 3000K | 4000K | 5000K |
|-----------------|-------------|-------|-------|-------|-------|-------|-------|-------|-------|
| WATTAGE         | 16W         |       |       | 13W   |       |       | 10W   |       |       |
| INPUT WATTS     | 16.4W       | 15.8W | 16.2W | 13W   | 12.8W | 12.9W | 10.5W | 10.4W | 10.5W |
| LUMENS          | 2,148       | 2,353 | 2,275 | 1,784 | 1,925 | 1,883 | 1,468 | 1,566 | 1,468 |
| EFFICACY        | 131.0       | 148.0 | 140.4 | 137.2 | 150.4 | 146.0 | 139.8 | 150.6 | 147.6 |
| CRI             | 81          | 84    | 83    | 82    | 84    | 83    | 82    | 84    | 83    |
| VOLTAGE RATINGS | 120 or 277V |       |       |       |       |       |       |       |       |

| X34S            | 3000K       | 4000K | 5000K | 3000K | 4000K | 5000K | 3000K | 4000K | 5000K |
|-----------------|-------------|-------|-------|-------|-------|-------|-------|-------|-------|
| WATTAGE         | 35W         |       |       | 25W   |       |       | 20W   |       |       |
| INPUT WATTS     | 33.6W       | 32.3W | 33.5W | 24.7W | 23.7W | 24.5W | 20W   | 19.6W | 19.9W |
| LUMENS          | 4,081       | 4,677 | 4,336 | 3,240 | 3,576 | 3,419 | 2,685 | 2,956 | 2,845 |
| EFFICACY        | 121.5       | 144.8 | 129.4 | 131.2 | 150.9 | 139.6 | 134.3 | 150.8 | 143.0 |
| CRI             | 81          | 84    | 83    | 81    | 84    | 83    | 81    | 84    | 83    |
| VOLTAGE RATINGS | 120 or 277V |       |       |       |       |       |       |       |       |

| X34M            | 3000K       | 4000K | 5000K | 3000K | 4000K | 5000K | 3000K | 4000K | 5000K |
|-----------------|-------------|-------|-------|-------|-------|-------|-------|-------|-------|
| WATTAGE         | 65W         |       |       | 55W   |       |       | 45W   |       |       |
| INPUT WATTS     | 66.8W       | 63.7W | 67W   | 54.4W | 52.1W | 54.4W | 43.7W | 42.6W | 43.8W |
| LUMENS          | 8,608       | 9,718 | 9,245 | 7,496 | 8,306 | 7,997 | 6,346 | 7,080 | 6,808 |
| EFFICACY        | 128.9       | 152.6 | 138.0 | 137.8 | 159.4 | 147.0 | 145.2 | 166.2 | 155.4 |
| CRI             | 80          | 83    | 82    | 83    | 83    | 83    | 83    | 83    | 83    |
| VOLTAGE RATINGS | 120 or 277V |       |       |       |       |       |       |       |       |

| X34XL           | 3000K    | 4000K  | 5000K  | 3000K  | 4000K  | 5000K  | 3000K  | 4000K  | 5000K  |
|-----------------|----------|--------|--------|--------|--------|--------|--------|--------|--------|
| WATTAGE         | 90W      |        |        | 80W    |        |        | 70W    |        |        |
| INPUT WATTS     | 93.6W    | 89.1W  | 93.1W  | 82.5W  | 79W    | 82.2W  | 70.9W  | 68.1W  | 70.7W  |
| LUMENS          | 12,804   | 14,040 | 13,440 | 11,639 | 12,676 | 12,218 | 10,313 | 11,140 | 10,885 |
| EFFICACY        | 136.8    | 157.6  | 144.4  | 141.1  | 160.5  | 148.6  | 145.5  | 163.6  | 154.0  |
| CRI             | 83       | 86     | 85     | 83     | 86     | 85     | 83     | 86     | 85     |
| VOLTAGE RATINGS | 120-277V |        |        |        |        |        |        |        |        |

| X34XL           | 3000K    | 4000K  | 5000K  | 3000K  | 4000K  | 5000K  | 3000K  | 4000K  | 5000K  |
|-----------------|----------|--------|--------|--------|--------|--------|--------|--------|--------|
| WATTAGE         | 130W     |        |        | 110W   |        |        | 95W    |        |        |
| INPUT WATTS     | 135.1W   | 128.4W | 134.3W | 117W   | 112W   | 116.5W | 101.2W | 97.3W  | 100.9W |
| LUMENS          | 18,281   | 20,065 | 19,243 | 16,376 | 17,878 | 17,262 | 14,615 | 15,814 | 15,456 |
| EFFICACY        | 135.3    | 156.3  | 143.2  | 140.0  | 159.6  | 148.2  | 144.4  | 162.5  | 153.2  |
| CRI             | 783      | 86     | 85     | 83     | 86     | 85     | 83     | 86     | 85     |
| VOLTAGE RATINGS | 120-277V |        |        |        |        |        |        |        |        |

| X34XXL          | 3000K    | 4000K  | 5000K  | 3000K  | 4000K  | 5000K  | 3000K  | 4000K  | 5000K  |
|-----------------|----------|--------|--------|--------|--------|--------|--------|--------|--------|
| WATTAGE         | 160W     |        |        | 140W   |        |        | 120W   |        |        |
| INPUT WATTS     | 160.4W   | 153.4W | 160.9W | 141.8W | 136.1W | 142.2W | 121W   | 116.4W | 121.7W |
| LUMENS          | 21,483   | 24,168 | 23,567 | 21,510 | 21,934 | 19,703 | 17,458 | 19,243 | 19,121 |
| EFFICACY        | 133.9    | 157.6  | 146.5  | 138.9  | 161.2  | 151.3  | 144.3  | 165.3  | 157.1  |
| CRI             | 83       | 86     | 85     | 83     | 86     | 85     | 83     | 86     | 85     |
| VOLTAGE RATINGS | 120-277V |        |        |        |        |        |        |        |        |

# X34 Field-Adjustable Floodlight



## PERFORMANCE

| X34S/RGB        | 2700K    | 3000K | 4000K | 5000K | 6500K |
|-----------------|----------|-------|-------|-------|-------|
| WATTAGE         | 30W      |       |       |       |       |
| INPUT WATTS     | 29.9W    | 29.9W | 30.0W | 30.0W | 30.0W |
| LUMENS          | 3,674    | 3,748 | 3,865 | 3,913 | 3,932 |
| EFFICACY        | 122.9    | 125.4 | 128.8 | 130.4 | 131.1 |
| CRI             | 80       |       |       |       |       |
| VOLTAGE RATINGS | 120-277V |       |       |       |       |

| X34M/RGB        | 2700K    | 3000K | 4000K | 5000K | 6500K |
|-----------------|----------|-------|-------|-------|-------|
| WATTAGE         | 60W      |       |       |       |       |
| INPUT WATTS     | 60.6W    | 60.0W | 59.8W | 59.6W | 60.0W |
| LUMENS          | 7,429    | 7,624 | 8,110 | 8,131 | 7,927 |
| EFFICACY        | 122.6    | 127.1 | 135.6 | 136.4 | 132.1 |
| CRI             | 80       |       |       |       |       |
| VOLTAGE RATINGS | 120-277V |       |       |       |       |

| X34L/RGB        | 2700K    | 3000K  | 4000K  | 5000K  | 6500K  |
|-----------------|----------|--------|--------|--------|--------|
| WATTAGE         | 90W      |        |        |        |        |
| INPUT WATTS     | 88.6W    | 88.7W  | 88.8W  | 88.7W  | 88.6W  |
| LUMENS          | 10,951   | 11,158 | 11,492 | 11,617 | 11,672 |
| EFFICACY        | 123.6    | 125.8  | 129.4  | 131    | 131.7  |
| CRI             | 80       |        |        |        |        |
| VOLTAGE RATINGS | 120-277V |        |        |        |        |

| X34MXXLRGB      | 2700K    | 3000K  | 4000K  | 5000K  | 6500K  |
|-----------------|----------|--------|--------|--------|--------|
| WATTAGE         | 160W     |        |        |        |        |
| INPUT WATTS     | 155.3W   | 155.1W | 155.1W | 155.1W | 155.1W |
| LUMENS          | 19,347   | 19,637 | 20,242 | 20,529 | 20,732 |
| EFFICACY        | 124.6    | 126.6  | 130.5  | 132.4  | 133.7  |
| CRI             | 80       |        |        |        |        |
| VOLTAGE RATINGS | 120-277V |        |        |        |        |

## ORDERING MATRIX

### X34

| Family       | Wattage                             | Mounting      | Color Temperature                    | Finish               | Driver         |
|--------------|-------------------------------------|---------------|--------------------------------------|----------------------|----------------|
| X34          |                                     |               |                                      |                      |                |
| XS<br>S<br>M | 16/13/10W<br>35/25/20W<br>65/55/45W | BLANK Knuckle | BLANK 3000/4000/5000K CCT Selectable | BLANK W Bronze White | BLANK 120/277V |

| Family         | Wattage                                  | Mounting                    | Color Temperature                    | Finish               | Driver                       | Option                            |
|----------------|--|-----------------------------|--------------------------------------|----------------------|------------------------------|-----------------------------------|
| X34            |  |                             |                                      |                      |                              |                                   |
| L<br>XL<br>XXL | 90/80/70W<br>130/110/95W<br>160/140/120W | BLANK T Slipfitter Trunnion | BLANK 3000/4000/5000K CCT Selectable | BLANK W Bronze White | BLANK 120-277V 0-10V Dimming | BLANK Selectable On/Off Photocell |

### X34 RGBW

| Family | Wattage    | Mounting      | Color Temperature                      | Finish               | Driver         | RGB Color Tuning        |
|--------|------------|---------------|--|----------------------|----------------|-------------------------|
| X34    |            |               |  |                      |                | /RGB                    |
| S<br>M | 30W<br>60W | BLANK Knuckle | BLANK 80 CRI, Tunable White 2200-6500K | BLANK W Bronze White | BLANK 120-277V | /RGB 16+ million Colors |

| Family   | Wattage     | Mounting                    | Color Temperature                      | Finish               | Driver         | RGB Color Tuning        |
|----------|-------------|-----------------------------|--|----------------------|----------------|-------------------------|
| X34      |             |                             |  |                      |                | /RGB                    |
| L<br>XXL | 90W<br>160W | BLANK T Slipfitter Trunnion | BLANK 80 CRI, Tunable White 2200-6500K | BLANK W Bronze White | BLANK 120-277V | /RGB 16+ million Colors |