



Wiremold

EFB6S-2HUB

Evolution Floor Box 2" Hub Adapter INSTALLATION INSTRUCTIONS

Installation Instruction No.: 1 010 787 – March 2012

Legrand/Wiremold electrical systems conform to and should be properly grounded in compliance with requirements of the current National Electrical Code or codes administered by local authorities.

All electrical products may present a possible shock or fire hazard if improperly installed or used. Legrand/Wiremold electrical products may bear the mark of a Nationally Recognized Testing Laboratory (NRTL) and should be installed in conformance with current local and/or the National Electrical Code.

IMPORTANT: Please read all instructions before beginning.

PRODUCTS COVERED: EFB6S-2HUB – For use with EFB6 & EFB6-OG Floor Boxes

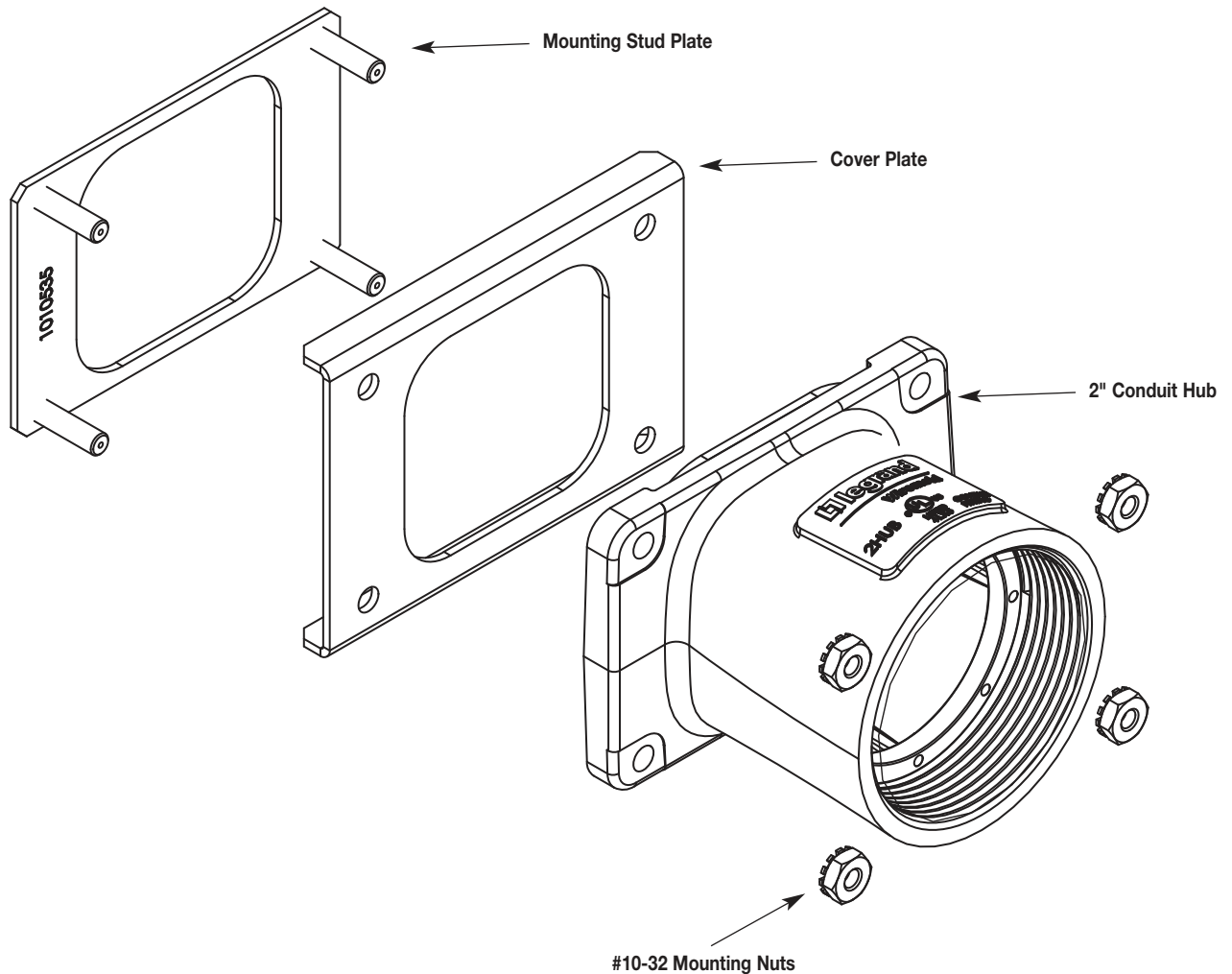

Step 1. Remove KO plate from desired location on the floor box for Hub placement. Use ¼" hex head driver to remove the two screws as shown.

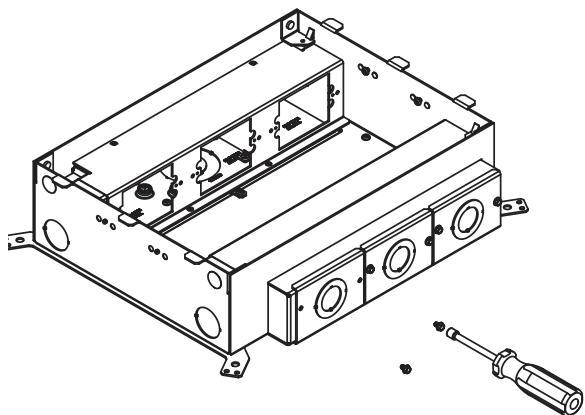

Step 2. For On-Grade Boxes: To facilitate the removal of the knock out plate, use a utility knife to score the paint around the edges of the plate as shown.

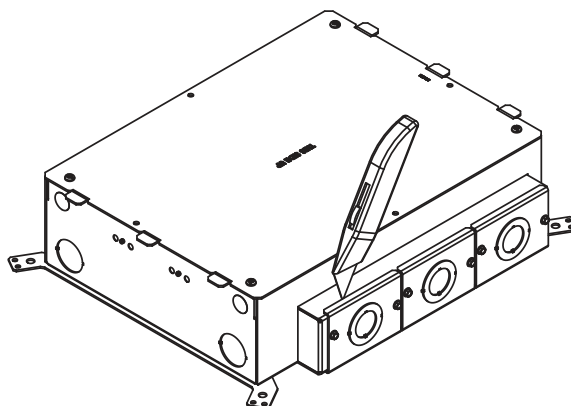

Step 3. Remove device plate on the inside of the floor box.

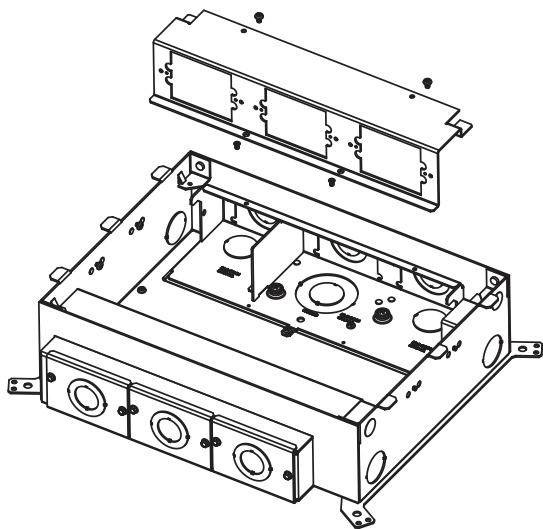

Step 4. Remove knock out plate by tapping the plate loose from the box as shown.

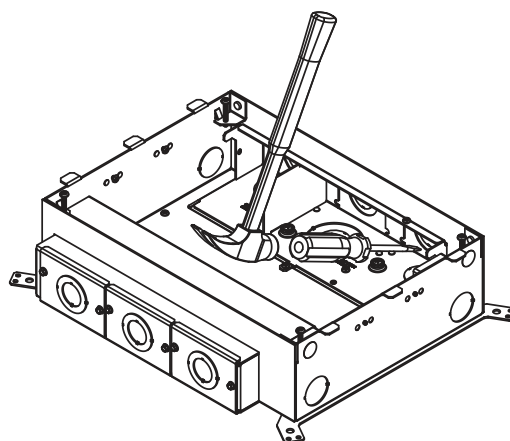

Step 5. Insert Mounting Stud plate on the inside of the floor box. Place Cover plate on the outside of the floor box. Position hub adapter onto the protruding studs and fasten together using the supplied #10-32 nuts.

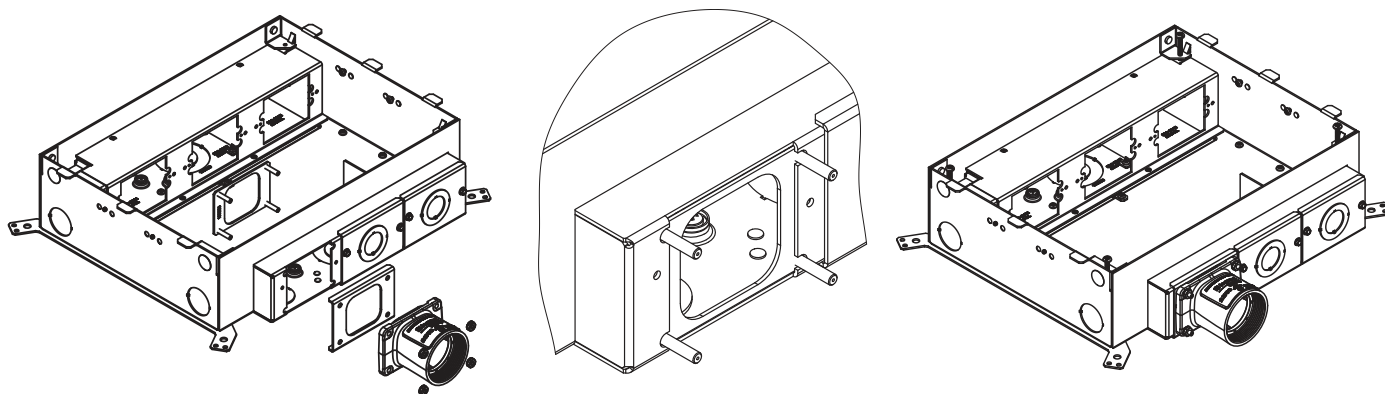

Step 6. Complete the installation by attaching 2 inch conduit to the Hub.

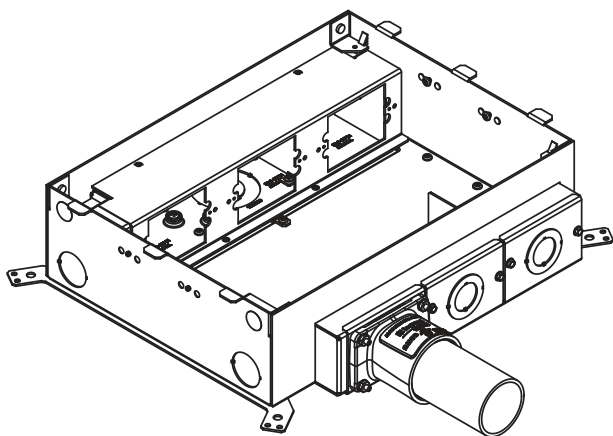



Wiremold

WIREMOLD

U.S. and International:

60 Woodlawn Street • West Hartford, CT 06110

1-800-621-0049 • FAX 860-232-2062 • Outside U.S.: 860-233-6251

Canada:

570 Applewood Crescent • Vaughan, Ontario L4K 4B4

1-800-723-5175 • FAX 905-738-9721

