



Desktop Power Center Slim puts smart USB charging where you need it.

Desktop Power Center Slim brings technology to the point-of-use

WSPC220, WSPC320, WSPC220C, WSPC320C

Add power and charging wherever it's needed. Desktop Power Center Slim offers sleek and easy-to-install solutions that mount directly on surfaces and minimize cord clutter. Perfect for desks, tabletops and workstations.

Features & Benefits

- **Multiple options.** Two versions with reliable power and charging – one with three (3) tamper-resistant power outlets and two (2) USB charging ports (3.1A) and one with two (2) tamper-resistant power outlets and two (2) USB charging ports (3.1A).
- **Intelligent and energy efficient.** Smart charging capability that recognizes devices and when to shut off during peak loads.
- **Easy connection to power sources.** 6' (1.83m) or 10' (3.05m) 14 gauge cord easily reaches walls and floors.
- **Simple and flexible installation.** Mounting kits include options for both horizontal and vertical applications.
- **Less clutter, more functionality.** A sleek slim design fits unobtrusively on work surfaces.
- **Seamlessly blends into your space.** Two color choices that work with any environment.
- **Table Thickness.** Supports tables from 0.5" to 1.5" for the clamp mount. Under table bracket mount supports 1" to 1.5".
- **Included Mounting Kit.** Includes several mounting options for use under and above table surfaces for any environment.



Compliance

Desktop Power Center Slim:

cETLus Listed Furniture Power Distribution Unit Listed to US & Canadian Safety Standards.

Desktop Power Center Slim Ordering Information

WSPC220BK WSPC220WH

Two Outlet, 2 USB-A Unit with Mounting Kit – Unit Includes two (2) 15A tamper-resistant power receptacles and two (2) smart USB ports that provide 3.1A. Unit comes with a 6' (1.83m) cord. Includes a screw-in mounting plate for forward-facing outlets, under table mount bracket, and clamp mounting kit. Available in matte black (WSPC220BK) or gloss white (WSPC220WH) with a gray face.

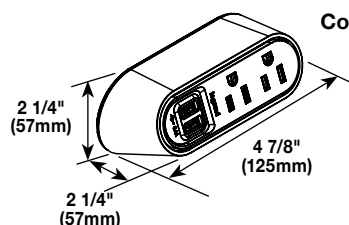

Country of Origin: China

WSPC320BK WSPC320WH

Three Outlet, 2 USB-A Unit with Mounting Kit – Unit Includes three (3) 15A tamper-resistant power receptacles and two (2) smart USB ports that provide 3.1A. Unit comes with a 6' (1.83m) cord. Includes a screw-in mounting plate for forward-facing outlets, under table mount bracket, and clamp mounting kit. Available in matte black (WSPC320BK) or gloss white (WSPC320WH) with a gray face.

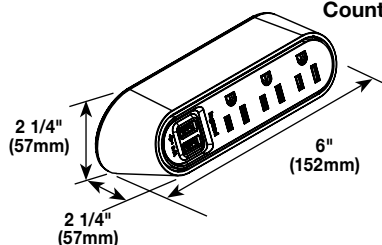

Country of Origin: China

6-Foot Power Cord: WSPC220CBK WSPC220CWH

10-Foot Power Cord: WSPC220CBK10 WSPC220CWH10

Two Outlet, 1 USB-A, 1 USB-C Unit with Mounting Kit – Unit Includes two (2) 15A tamper-resistant power receptacles and two (2) smart USB ports, one (1) USB-A and one (1) USB-C, that provide 3.1A. Unit comes with either a 6' (1.83m) or 10' (3.05m) cord. Includes a screw-in mounting plate for forward-facing outlets, under table mount bracket, and clamp mounting kit. Available in matte black (WSPC220CBK) or gloss white (WSPC220CWH) with a gray face.

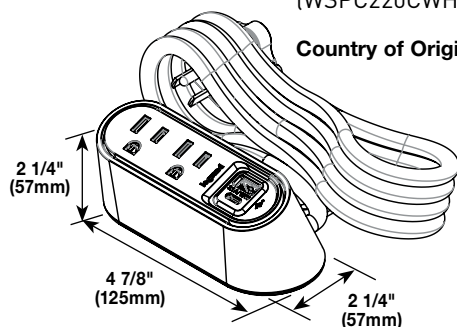

Country of Origin: China

6-Foot Power Cord: WSPC320CBK WSPC320CWH

10-Foot Power Cord: WSPC320CBK10 WSPC320CWH10

Two Outlet, 1 USB-A, 1 USB-C Unit with Mounting Kit – Unit Includes three (3) 15A tamper-resistant power receptacles and two (2) smart USB ports, one (1) USB-A and one (1) USB-C, that provide 3.1A. Unit comes with either a 6' (1.83m) or 10' (3.05m) cord. Includes a screw-in mounting plate for forward-facing outlets, under table mount bracket, and clamp mounting kit. Available in matte black (WSPC320CBK) or gloss white (WSPC320CWH) with a gray face.

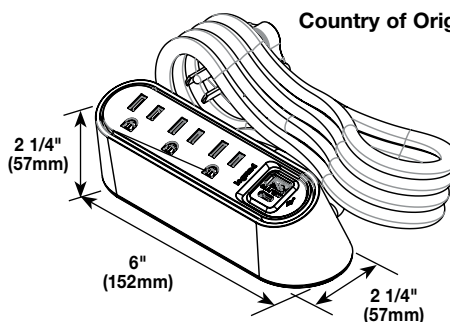

Country of Origin: China

Desktop Power Center Slim Mounting Options



Improved aesthetics with shroud for use in open space areas

Mounting Kit (included) – Kit includes clamp for screwless mounting shroud for clamp mount and right angle screw-in mounting plate. The two piece clamp allows the Desktop Power Center Slim to be installed against partition walls without dismantling them. The clamp allows the outlets to be mounted forward or upward facing. The right angle screw-in mounting plate allows the outlets to be mounted facing upward.

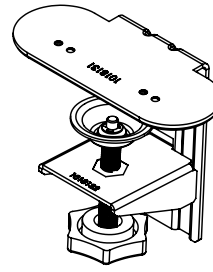

Clamp

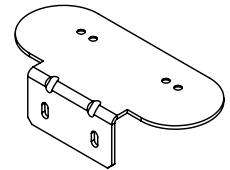

Right Angle Screw-In
Mounting Plate



Screw-in Mounting Plate



Right Angle Screw-in Mounting Plate



Mounting Bracket for Under Table
Applications



WSPC320WH mounted horizontally on work surface



WSPC220 Desktop Power Centers feature a pass-through plug that retains access to outlets. Note: WSPC320 units do not feature a pass-through plug.

Vertical Markets

- | | | | |
|---------------|-------------|-----------------|-----------|
| • Commercial | • Education | • Entertainment | • Retail |
| • Hospitality | • Parks | • Healthcare | • Transit |

NOTE: All brand and product names referenced in this document are registered trademarks or trademarks of their respective holders.



Legrand, North America
60 Woodlawn Street
West Hartford, CT 06110
1.877.BY.LEGRAND (295.3472)
www.legrand.us

Canada
905.738.9195
www.legrand.ca

